

**A402500**  
MALE PLUG JIC  
Złoczone MSK JIC

Nr części	Gwint		Wymiary	
	T1 (UNF)	L	H1	H2
A402500-04	7/16" - 20	20,0	14	10,5
A402500-05	1/2" - 20	21,0	14	10,5
A402500-06	9/16" - 18	23,0	16	12,5
A402500-08	3/4" - 16	25,0	22	14,5
A402500-10	7/8" - 14	29,0	24	16,5
A402500-12	1 1/16" - 12	33,0	30	18,5
A402500-14	1 3/16" - 12	34,0	32	19,5
A402500-16	1 5/16" - 12	36,0	34	20,5
A402500-20	1 5/8" - 12	41,0	43	25,5
A402500-24	1 7/8" - 12	44,0	50	28,5

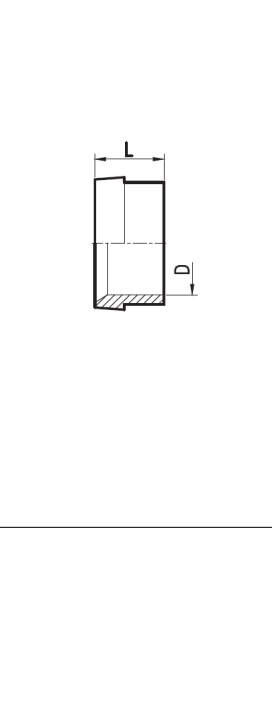

**A412500**  
FEMALE PLUG JIC  
Złoczone MSK JIC

Nr części	Gwint		Wymiary	
	T1 (UNF)	L	H1	H2
A412500-04	7/16" - 20	20,0	16	11,5
A412500-05	1/2" - 20	21,0	16	11,5
A412500-06	9/16" - 18	23,0	18	13,5
A412500-08	3/4" - 16	25,0	22	15,5
A412500-10	7/8" - 14	32,0	27	18,5
A412500-12	1 1/16" - 12	34,0	32	20,5
A412500-14	1 3/16" - 12	34,0	33	21,5
A412500-16	1 5/16" - 12	36,0	34	22,5
A412500-20	1 5/8" - 12	41,0	43	27,5
A412500-24	1 7/8" - 12	48,0	55	31,5

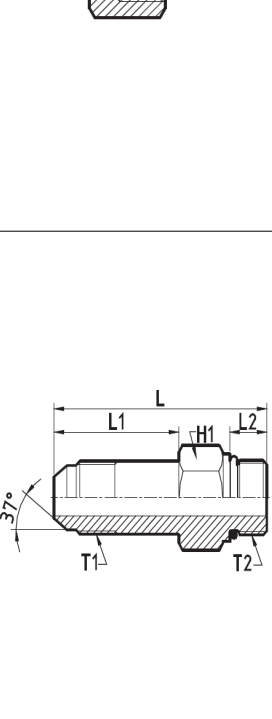

**A422500**  
SLEEVE JIC  
Złoczone MSK JIC

Nr części	Gwint		Wymiary	
	T1 (UNF)	D	L	H
A422500-04-04	7/16" - 20	6	10,5	6
A422500-08-05	1/2" - 20	8	11,5	7
A422500-10-06	9/16" - 18	10	12,5	8
A422500-12-08	3/4" - 16	12	14,5	10
A422500-14-10	7/8" - 14	14	16,5	12
A422500-16-10	7/8" - 14	15	16,5	12
A422500-16-10	7/8" - 14	16	16,5	12
A422500-18-12	1 1/16" - 12	18	17,0	13
A422500-20-12	1 1/16" - 12	20	17,0	13
A422500-25-16	1 5/16" - 12	25	19,5	15
A422500-30-20	1 5/8" - 12	30	23,0	18
A422500-32-20	1 5/8" - 12	32	23,0	18
A422500-38-24	1 7/8" - 12	38	28,5	21



**A432500**  
NUT JIC  
Złoczone MSK JIC

Nr części	Gwint		Wymiary	
	T1 (UNF)	T2 (NPTF)	L	H1
A432500-06-04	6 7/16" - 20	15,5	16	11
A432500-08-05	8 1/2" - 20	17,0	17	11
A432500-10-06	10 9/16" - 18	18,5	18	11
A432500-12-08	12 3/4" - 16	21,5	22	12
A432500-14-10	14 7/8" - 14	24,5	27	13
A432500-16-10	16 7/8" - 14	24,5	27	13
A432500-16-10	16 1 1/16" - 12	26,0	32	14
A432500-18-12	18 1 1/16" - 12	26,0	32	14
A432500-25-16	25 1 5/16" - 12	28,5	38	15
A432500-30-20	30 1 5/8" - 12	31,0	50	16
A432500-32-20	32 1 5/8" - 12	31,0	50	16
A432500-38-24	38 1 7/8" - 12	36,0	55	17



**A502230**  
STRAIGHT ADAPTOR JIC  
MALE BULKHEAD 7/4" CONE  
SEAT  
SAE MALE O-RING  
BOSS TYPE  
(SAE J1939)

Nr części	Gwint		Wymiary	
	T1 (UNF)	T2 (UNF)	L	L1 L2 H1 H2
A502230-04-04	7/16" - 20	7/16" - 20	53,0	35,5 9,5 14
A502230-05-05	1/2" - 20	1/2" - 20	54,5	37,0 9,5 16
A502230-06-06	9/16" - 18	9/16" - 18	58,5	39,5 10,0 19
A502230-08-08	3/4" - 16	3/4" - 16	68,5	48,0 11,5 22
A502230-10-10	7/8" - 14	7/8" - 14	77,0	53,0 13,0 27
A502230-12-12	1 1/16" - 12	1 1/16" - 12	91,5	63,5 15,5 32
A502230-16-16	1 5/16" - 12	1 5/16" - 12	110,0	72,0 15,5 38
A502230-20-20	1 5/8" - 12	1 5/8" - 12	119,0	80,0 15,5 50
A502230-24-24	1 7/8" - 12	1 7/8" - 12	130,5	98,5 15,5 55
A502230-32-32	2 1/2" - 12	2 1/2" - 12	160,0	123,0 15,5 70

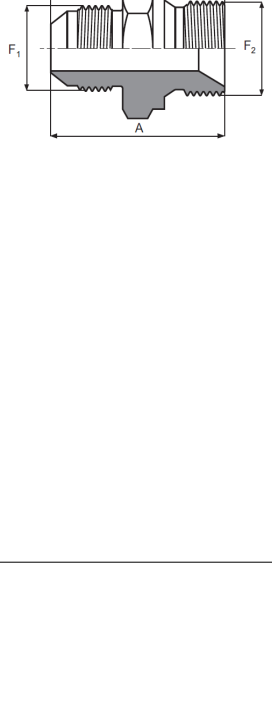

**A502328**  
STRAIGHT ADAPTOR JIC  
MALE BULKHEAD 7/4" CONE  
SEAT  
(SAE J514)  
NPTF MALE 60° CONE SEAT  
(SAE J514)

Nr części	Gwint		Wymiary	
	T1 (UNF)	T2 (NPTF)	L	H1 H3
A502328-04-04	7/16" - 20	1/4" - 18	52,8	27 17
A502328-06-06	9/16" - 18	1/4" - 18	55,8	27 22
A502328-08-08	3/4" - 16	3/8" - 18	61,7	24 24
A502328-10-08	7/8" - 14	1/2" - 14	71,1	30 30
A502328-12-12	1 1/16" - 12	3/4" - 14	74,2	36 36
A502328-16-16	1 5/16" - 12	1" - 11,5	78,7	41 41

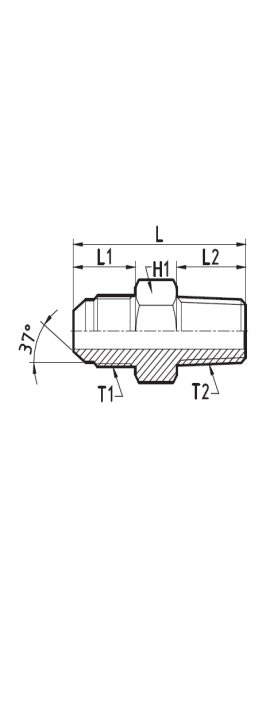

**A502503**  
STRAIGHT ADAPTOR JIC  
MALE 7/4" CONE  
SEAT  
(SAE J514)  
BSP MALE O-RING  
BOSS TYPE  
(ISO 1739)

Nr części	Gwint		Wymiary	
	T1 (UNF)	T2 (BSP)	L	L1 L2 H1 H2
A502503-04-02	7/16" - 20	1/8" - 28	30,0	15,0 8,5 14
A502503-04-04	7/16" - 20	1/4" - 19	36,0	16,0 12,0 19
A502503-04-06	7/16" - 20	3/8" - 19	36,5	16,0 12,0 22
A502503-04-08	7/16" - 20	1/2" - 14	40,5	16,0 14,0 27
A502503-05-02	1/2" - 20	1/8" - 28	30,0	15,0 8,5 14
A502503-05-04	1/2" - 20	1/4" - 19	36,5	16,0 12,0 19
A502503-05-06	1/2" - 20	3/8" - 19	36,5	16,0 12,0 22
A502503-05-08	1/2" - 20	1/2" - 14	40,5	16,0 14,0 27
A502503-06-04	9/16" - 18	1/4" - 19	37,0	17,0 12,0 19
A502503-06-06	9/16" - 18	3/8" - 19	37,0	17,0 12,0 22
A502503-06-08	9/16" - 18	1/2" - 14	41,0	17,0 14,0 27
A502503-08-04	3/4" - 16	1/4" - 19	39,0	18,0 12,0 19
A502503-08-06	3/4" - 16	3/8" - 19	39,0	18,0 12,0 22
A502503-08-08	3/4" - 16	1/2" - 14	43,0	19,0 14,0 27
A502503-08-12	3/4" - 16	3/4" - 14	47,0	19,0 16,0 32
A502503-10-06	7/8" - 14	3/8" - 19	42,0	21,0 12,0 22
A502503-10-08	7/8" - 14	1/2" - 14	45,0	21,0 14,0 27
A502503-10-12	7/8" - 14	3/4" - 14	49,0	21,0 16,0 32
A502503-12-08	1 1/16" - 12	1/2" - 14	48,0	24,0 14,0 27
A502503-12-12	1 1/16" - 12	3/4" - 14	52,0	24,0 16,0 32
A502503-12-16	1 3/16" - 12	1" - 11	60,0	26,0 18,0 41
A502503-14-12	1 3/16" - 12	3/4" - 14	54,0	23,0 16,0 32
A502503-16-16	1 5/16" - 12	1" - 11	55,0	25,0 18,0 41
A502503-16-20	1 5/16" - 12	1 1/4" - 11	60,0	26,0 20,0 50
A502503-20-16	1 5/8" - 12	1" - 11	60,0	26,0 18,0 41
A502503-20-20	1 5/8" - 12	1 1/4" - 11	62,0	28,0 20,0 50
A502503-24-20	1 7/8" - 12	1 1/4" - 11	64,0	30,0 20,0 50
A502503-24-24	1 7/8" - 12	1 1/2" - 11	67,0	30,0 22,0 55

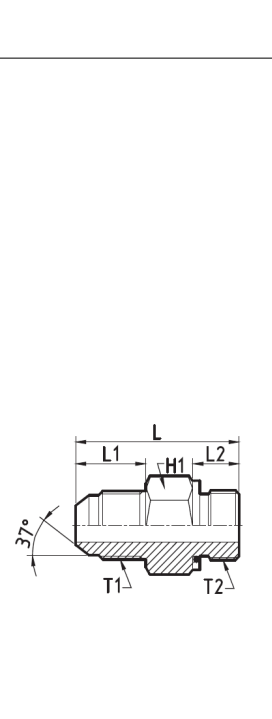

**A502505**  
JIC MALE  
(SAE J514)  
BSP MALE  
60° CONE SEAT  
(ISO 228)

Nr części	Gwint		Wymiary	
	F1 (UNF)	F2 (BSP)	A	B C H1
A502505-04-02	7/16" - 20	1/8" - 28	30,0	14,0 10,0 14
A502505-04-04	7/16" - 20	1/4" - 19	32,0	14,0 12,0 19
A502505-04-06	7/16" - 20	3/8" - 19	34,5	14,0 12,0 22
A502505-05-04	1/2" - 20	1/4" - 19	34,5	14,0 12,0 19
A502505-05-06	1/2" - 20	3/8" - 19	34,5	14,0 12,0 22
A502505-06-06	9/16" - 18	3/8" - 19	35,0	14,0 13,0 22
A502505-08-08	9/16" - 18	1/2" - 14	38,0	14,0 14,0 27
A502505-08-04	3/4" - 16	1/4" - 19	37,5	17,0 12,0 19
A502505-08-06	3/4" - 16	3/8" - 19	38,5	16,5 13,5 22
A502505-08-08	3/4" - 16	1/2" - 14	41,0	17,0 14,0 27
A502505-08-12	3/4" - 16	3/4" - 14	45,0	17,0 16,0 32
A502505-10-06	7/8" - 14	3/8" - 19	40,5	19,5 12,0 22
A502505-10-08	7/8" - 14	1/2" - 14	45,0	19,5 12,0 27
A502505-10-12	7/8" - 14	3/4" - 14	49,0	19,5 16,5 32
A502505-12-08	1 1/16" - 12	1/2" - 14	47,0	22,0 16,0 32
A502505-12-16	1 1/16" - 12	1" - 11	62,5	22,0 18,0 41
A502505-14-12	1 3/16" - 12	3/4" - 14	50,0	22,5 16,0 32
A502505-16-12	1 5/16" - 12	1" - 11	61,0	23,0 16,0 35
A502505-16-16	1 5/16" - 12	1" - 11	63,5	23,0 18,0 41
A502505-20-16	1 5/8" - 12	1 1/4" - 11	65,0	24,5 20,0 50
A502505-20-20	1 5/8" - 12	1 1/4" - 11	67,5	24,5 20,0 50
A502505-24-20	1 7/8" - 12	1 1/4" - 11	61,5	27,5 20,0 50
A502505-24-24	1 7/8" - 12	1 1/2" - 11	65,5	27,5 22,0 55

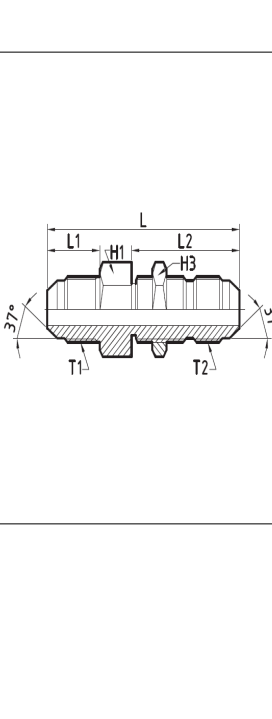

**A502507**  
STRAIGHT ADAPTOR JIC  
MALE 7/4" CONE  
SEAT  
(SAE J514)  
BSP MALE O-RING  
BOSS TYPE  
(ISO 1739)

Nr części	Gwint		Wymiary	
	T1 (UNF)	T2 (BSP)	L	L1 L2 H1 H2
A502507-04-04	7/16" - 20	1/8" - 28	31,0	14,0 10,0 12
A502507-04-02	7/16" - 20	1/4" - 19	34,0	14,0 14,0 14
A502507-04-06	7/16" - 20	3/8" - 19	40,0	16,0 16,0 19
A502507-05-02	1/2" - 20	1/8" - 28	32,0	15,0 11,0 14
A502507-05-04	1/2" - 20	1/4" - 19	36,0	15,0 14,0 14
A502507-05-06	1/2" - 20	3/8" - 19	40,0	16,0 16,0 19
A502507-05-08	1/2" - 20	1/2" - 14	44,0	16,0 18,0 22
A502507-06-02	9/16" - 18	1/8" - 28	33,0	16,0 11,0 14
A502507-06-04	9/16" - 18	1/4" - 19	36,0	16,0 14,0 14
A502507-06-06	9/16" - 18	3/8" - 19	40,0	16,0 16,0 19
A502507-06-08	9/16" - 18	1/2" - 14	44,0	17,0 18,0 22
A502507-08-04	3/4" - 16	1/4" - 19	40,0	18,0 14,0 19
A502507-08-06	3/4" - 16	3/8" - 19	41,0	18,0 16,0 19
A502507-08-08	3/4" - 16	1/2" - 14	45,0	18,0 20,0 27
A502507-08-12	3/4" - 16	3/4" - 14	49,0	19,0 20,0 27
A502507-10-06	7/8" - 14	3/8" - 19	42,0	20,0 16,0 22
A502507-10-08	7/8" - 14	1/2" - 14	46,0	20,0 18,0 22
A502507-10-12	7/8" - 14	3/4" - 14	50,0	20,0 20,0 27
A502507-12-08	1 1/16" - 12			

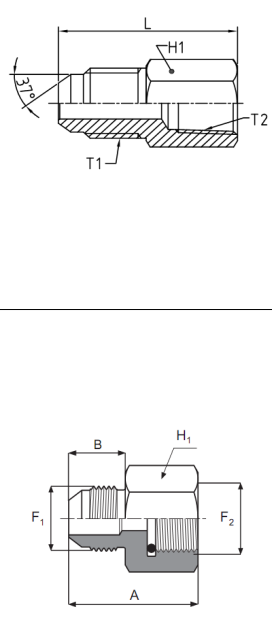

**A522534**  
 STRAIGHT ADAPTOR  
 JIC MALE 74° CONE  
 NPT/F FIXED FEMALE  
 (SAE J514)  
 Adaptor prosty  
 JIC męski socket 74°  
 NPT/F stały żeński

Nr części	Gwint		Wymiary		
	T1 (UNF)	T2 (NPT/F)	L	H1	H2
A522534-04-04	7/16"-20	7/16"-20	114	18	35,3
A522534-05-04	1/2"-20	1/4"-18	114	18	35,3
A522534-06-04	9/16"-18	1/4"-18	114	18	35,6
A522534-06-06	9/16"-18	3/8"-18	37	22	22
A522534-08-08	3/4"-16	1/2"-14	45,5	27	27
A522534-10-10	7/8"-14	1/2"-14	48	27	27
A522534-12-12	1 1/16"-12	1 1/16"-12	55,5	31,5	32
A522534-16-16	1 5/16"-12	1 1/8"-12	65	35	38
A522534-20-20	1 5/8"-12	1 1/4"-11,5	63,5	50	50

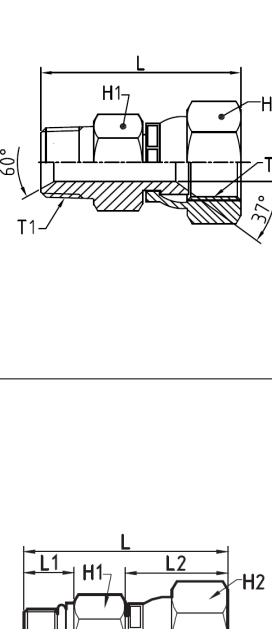

**A522553**  
 JIC MALE  
 (SAE J514)  
 BSP PRESSURE GAUGE  
 JIC męski  
 BSP płęzce ciśnieniowe  
 pomiarowe

Nr części	Gwint		Wymiary		
	F1 (UNF)	F2 (BSPP)	A	B	H1
A522553-04-04	7/16"-20	1/8"-28	22	18,5	14
A522553-04-08	7/16"-20	1/2"-14	19	31	14
A522553-05-04	1/2"-20	1/2"-14	19	28	14
A522553-05-08	1/2"-20	1/2"-14	19	28	14
A522553-06-04	9/16"-18	1/4"-18	19	28	14
A522553-06-08	9/16"-18	3/8"-18	19	28	14
A522553-08-08	3/4"-16	1/2"-14	31	17	19
A522553-08-08	3/4"-16	1/2"-14	38	17	27

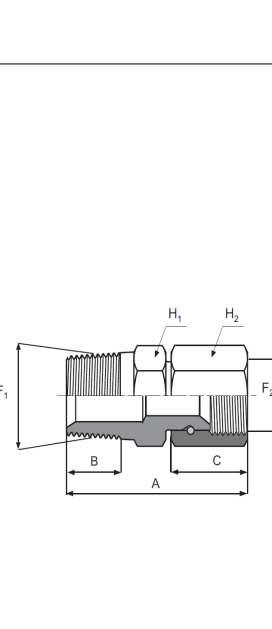

**A522825**  
 STRAIGHT ADAPTOR  
 NPT/F MALE  
 60° CONE SEAT  
 JIC FEMALE  
 74° CONE SEAT  
 (SAE J514)  
 Adaptor prosty  
 NPT/F męski  
 60° grzązdo socketowe  
 JIC żeński  
 74° grzązdo socketowe

Nr części	Gwint		Wymiary		
	T1 (NPT/F)	T2 (UNF)	L	H1	H2
A522825-02-04	1/8"-27	7/16"-20	34,3	13	16
A522825-04-04	1/4"-18	7/16"-20	39,6	16	16
A522825-04-06	1/4"-18	9/16"-18	42,6	14	19
A522825-06-06	3/8"-18	3/8"-18	41,4	19	19
A522825-06-08	3/8"-18	1/2"-14	43,9	22	22
A522825-08-08	1/2"-14	3/4"-16	50,9	27	27
A522825-12-12	1 1/16"-12	1 1/16"-12	57,9	32	32
A522825-16-16	1 1/8"-12	1 5/16"-12	65	35	38
A522825-20-20	1 1/4"-11,5	1 5/8"-12	72	44	50

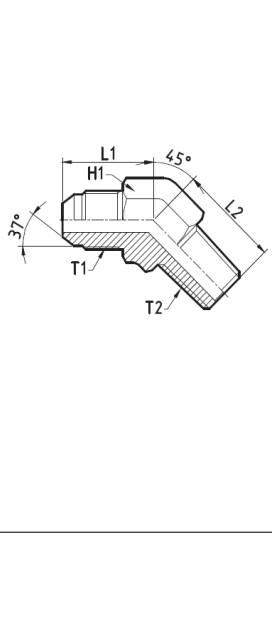

**A523025**  
 STRAIGHT ADAPTOR  
 SAE MALE O-RING  
 BOSS TYPE  
 (SAE J308)  
 JIC FEMALE  
 74° CONE SEAT  
 (SAE J514)  
 Adaptor prosty  
 SAE męski o-ringowy  
 typu BOSS  
 JIC żeński  
 74° grzązdo socketowe

Nr części	Gwint		Wymiary		
	T1 (UNF)	T2 (UNF)	L	L1	H1
A523025-04-04	7/16"-20	7/16"-20	32,5	9,5	17
A523025-05-05	1/2"-20	1/2"-20	36	9,5	16
A523025-06-06	9/16"-18	9/16"-18	37,5	10	19,5
A523025-08-08	3/4"-16	3/4"-16	43,5	11,5	23,5
A523025-10-10	7/8"-14	7/8"-14	48	13	25
A523025-12-12	1 1/16"-12	1 1/16"-12	55,5	15,5	27,5
A523025-14-14	1 3/16"-12	1 3/16"-12	64,5	17,5	27
A523025-16-16	1 5/16"-12	1 5/16"-12	69	18,5	31
A523025-20-20	1 5/8"-12	1 7/8"-12	82,5	19,5	32
A523025-24-24	1 7/8"-12	1 7/8"-12	88	15,5	35,5

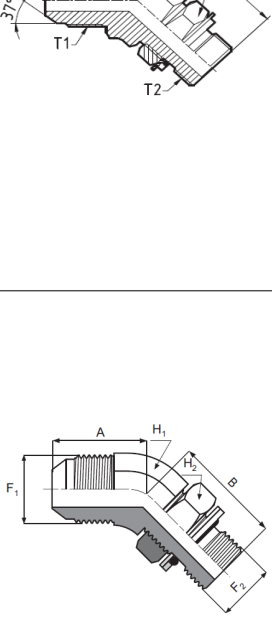

**A523525**  
 NPT MALE  
 (SAE J514)  
 74° CONE SEAT  
 (SAE J514)  
 NPT męski  
 JIC żeński  
 74° grzązdo socketowe

Nr części	Gwint		Wymiary		
	F1 (NPT)	F2 (UNF)	A	B	C
A523525-02-04	7/16"-20	1/8"-27	35,5	18,5	10
A523525-04-04	7/16"-20	1/4"-18	40	18,5	14,5
A523525-04-05	1/2"-20	1/4"-18	37,5	15	17
A523525-04-06	9/16"-18	1/4"-18	43,5	15,5	14,5
A523525-06-06	9/16"-18	3/8"-18	43,5	21,5	14,5
A523525-06-08	9/16"-18	1/2"-14	45,5	19,5	18
A523525-08-08	3/4"-16	3/8"-18	45	23	14,5
A523525-08-10	3/4"-16	1/2"-14	51,5	23	19
A523525-08-12	3/4"-16	1/2"-14	54,5	26	14,5
A523525-10-10	7/8"-14	1/2"-14	64,5	26	19
A523525-12-12	1 1/16"-12	1 1/16"-12	71,5	19	30
A523525-12-12	1 1/16"-12	3/4"-16	78,5	19	30
A523525-12-16	1 5/16"-12	1 1/8"-12	82,5	30	24
A523525-16-16	1 5/16"-12	1 1/8"-12	82,5	30	24
A523525-20-20	1 5/8"-12	1 1/4"-11,5	70,5	33	24,5

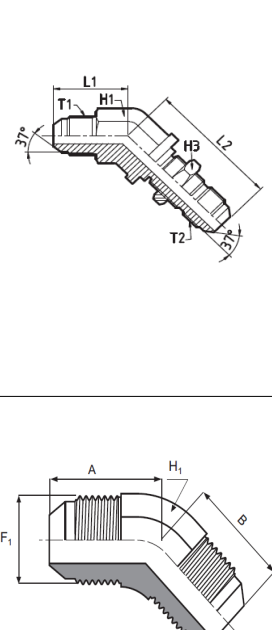

**A523507**  
 45° ELBOW ADAPTOR  
 JIC MALE 74° CONE  
 (SAE J514)  
 BSP MALE TAPERED  
 (ISO 7)  
 Adaptor kątowny 45°  
 JIC męski socket 74°  
 BSP męski gwint szliskoowy

Nr części	Gwint		Wymiary		
	T1 (UNF)	T2 (BSPT)	L1	L2	H1
A523507-04-02	7/16"-20	1/8"-28	22	18	14
A523507-04-04	7/16"-20	1/4"-18	22	21	14
A523507-05-04	1/2"-20	1/4"-18	22	21	14
A523507-06-04	9/16"-18	1/4"-18	22	21	14
A523507-06-06	9/16"-18	3/8"-18	26	26	19
A523507-08-06	3/4"-16	3/8"-18	26	26	19
A523507-08-08	3/4"-16	1/2"-14	28	31	22
A523507-10-08	7/8"-14	1/2"-14	28	31	22
A523507-12-12	1 1/16"-12	1 1/16"-12	34,5	31,5	27
A523507-16-16	1 5/16"-12	1 1/8"-12	40	41	35
A523507-20-20	1 5/8"-12	1 1/4"-11,5	46	46	44
A523507-24-24	1 7/8"-12	1 7/8"-12	49	46,5	50
A523507-32-32	2 1/2"-12	2 1/2"-11	58	55	65

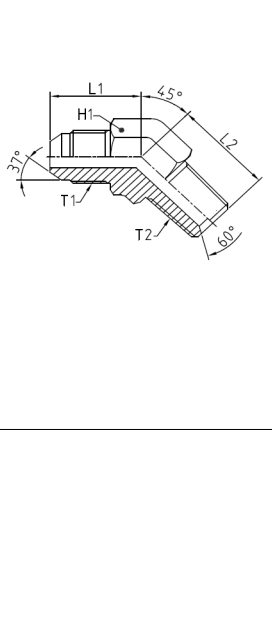

**A523509**  
 45° ELBOW ADJUSTABLE  
 ADAPTOR  
 JIC MALE 74° CONE  
 (SAE J514)  
 BOSS TYPE  
 (ISO 1179-3)  
 Adaptor kątowny 45°  
 nastawny  
 JIC męski socket 74°  
 BSP męski o-ringowy  
 typu BOSS

Nr części	Gwint		Wymiary		
	T1 (UNF)	T2 (BSPP)	L1	L2	H1
A523509-04-02	7/16"-20	1/8"-28	22	26,5	14
A523509-04-04	7/16"-20	1/4"-18	22	28	14
A523509-05-04	1/2"-20	1/4"-18	22	28	14
A523509-06-04	9/16"-18	1/4"-18	22	28	14
A523509-06-06	9/16"-18	3/8"-18	25	33	19
A523509-08-06	3/4"-16	3/8"-18	26	33	19
A523509-08-08	3/4"-16	1/2"-14	28	38,5	22
A523509-10-08	7/8"-14	1/2"-14	30	38,5	22
A523509-12-12	1 1/16"-12	1 1/16"-12	34,5	43	27
A523509-16-16	1 5/16"-12	1 1/8"-12	42	47	35
A523509-20-20	1 5/8"-12	1 1/4"-11,5	46	48,5	44

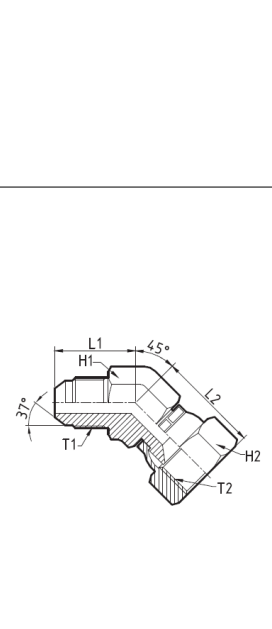

**A523519**  
 JIC męski  
 METRIC MALE CRING  
 (SAE J514)  
 (ISO 4199-2)  
 45° ELBOW  
 JIC męski  
 METRIC żeński  
 z o-ringiem typu BOSS  
 kątowny 45°

Nr części	Gwint		Wymiary		
	F1 (UNF)	F2 (METR)	A	B	C
A523519-05-12	1/2"-20	M12x1,5	21	29	14
A523519-06-16	9/16"-18	M18x1,5	22	33	14
A523519-08-18	3/4"-16	M18x1,5	25	33	19
A523519-10-18	7/8"-14	M22x1,5	28	35	22
A523519-12-22	1 1/16"-12	M22x1,5	32,5	40,5	27
A523519-12-22	1 1/16"-12	M27x2,0	32,5	44	27
A523519-16-27	1 5/16"-12	M27x2,0	37	47	35
A523519-16-33	1 5/16"-12	M33x2,0	37	47	35



**A523523**  
 45° ELBOW  
 BULKHEAD ADAPTOR  
 JIC MALE 74° CONE  
 (SAE J514)  
 Adaptor kątowny 45°  
 grzybiasty  
 JIC męski socket 74°

Nr części	Gwint		Wymiary		
	T1 (UNF)	T2 (UNF)	L1	L2	H1
A523523-04-04	7/16"-20	7/16"-20	22	39	14
A523523-05-05	1/2"-20	1/2"-20	22	39	14
A523523-06-06	9/16"-18	9/16"-18	22	42,5	14
A523523-08-08	3/4"-16	3/4"-16	26	49	19
A523523-10-10	7/8"-14	7/8"-14	30	55	22
A523523-12-12	1 1/16"-12	1 1/16"-12	32,5	67	32
A523523-20-20	1 5/8"-12	1 5/8"-12	46	67	41
A523523-24-24	1 7/8"-12	1 7/8"-12	49	67,5	50



**A523525**  
 JIC MALE  
 (SAE J514)  
 45° ELBOW  
 JIC męski  
 kątowny 45°

Nr części	Gwint		Wymiary		
	F1 (UNF)	F2 (BSPT)	A	B	H1
A523525-04-04	7/16"-20	23,5	23,5	14	
A523525-05-05	1/2"-20	23,5	23,5	14	
A523525-06-06	9/16"-18	25,0	25,0	14	
A523525-10-10	7/8"-14	32,0	32,0	22	

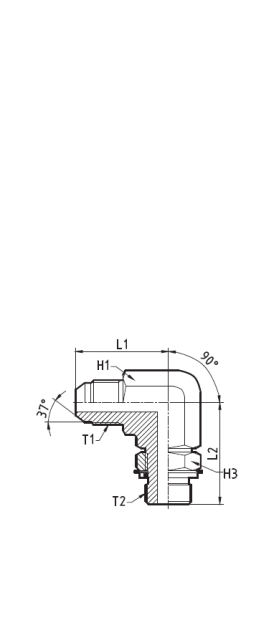

**A523528**  
 45° ELBOW ADAPTOR  
 JIC MALE 74° CONE  
 (SAE J514)  
 NPT/F MALE 60° CONE SEAT  
 (SAE J514)  
 Adaptor kątowny 45°  
 JIC męski socket 74°  
 NPT/F męski  
 60° grzązdo socketowe

Nr części	Gwint		Wymiary		
	T1 (UNF)	T2 (NPT/F)	L1	L2	H1
A523528-04-02	7/16"-20	1/8"-27	18,3	16,3	11
A523528-04-04	7/16"-20	1/4"-18	20,8	21,8	14
A523528-05-04	1/2"-20	1/4"-18	20,8	21,8	14
A523528-06-04	9/16"-18	1/4"-18	21,0	21,8	14
A523528-06-06	9/16"-18	3/8"-18	22,1	24,1	19
A523528-08-08	3/4"-16	1/2"-14	25,2	29,7	22
A523528-10-08	7/8"-14	1/2"-14	28,2	29,7	22
A523528-12-12	1 1/16"-12	1 1/16"-12	34,5	36,5	27
A523528-16-16	1 5/16"-12	1 1/8"-12	40,4	42,4	33
A523528-20-20	1 5/8"-12	1 1/4"-11,5	40,4	42,4	33

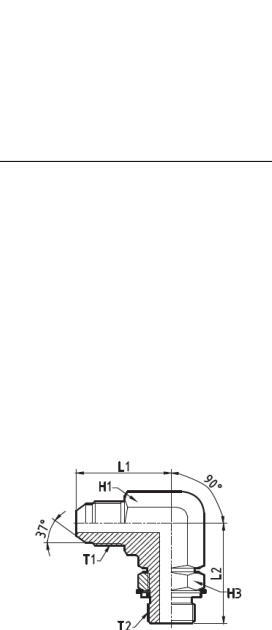

**A523531**  
 45° ELBOW ADJUSTABLE  
 ADAPTOR  
 JIC MALE 74° CONE  
 (SAE J514)  
 SAE MALE O-RING  
 BOSS TYPE  
 (SAE J308)  
 Adaptor kątowny 45°  
 nastawny  
 JIC męski socket 74°  
 SAE męski o-ringowy  
 typu BOSS

Nr części	Gwint		Wymiary		
	T1 (UNF)	T2 (UNF)	L1	L2	H1
A523531-04-04					

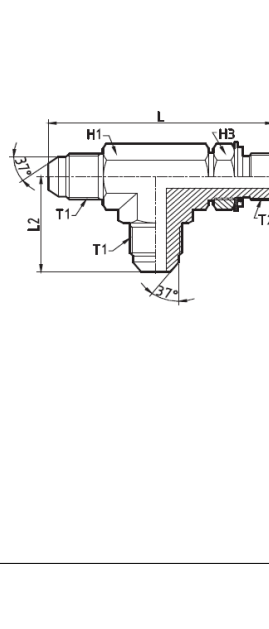

**A762509**  
RUN TEE ADJUSTABLE  
JIC MALE 74° CONE  
(SAE J514)  
BSP MALE O-RING  
BOSS TYPE  
(ISO 1179-3)

Trójnik asymetryczny  
nastawny  
JIC męski sztok 74°  
BSP męski z o-ringiem typu  
BOSS

Nr części	Gwint			Wymiary		
	T1 (UNF)	T2 (BSP)	L	L1	H1	H3
A762509-04-04	7/16" - 20	1/4" - 19	56,5	25,0	14	18
A762509-04-06	7/16" - 20	3/8" - 19	65,0	28,5	19	22
A762509-05-04	1/2" - 20	1/4" - 19	56,5	25,0	14	18
A762509-05-06	1/2" - 20	3/8" - 19	65,0	28,5	19	22
A762509-06-04	9/16" - 18	1/4" - 19	56,5	25,0	14	18
A762509-06-06	9/16" - 18	3/8" - 19	65,0	28,5	19	22
A762509-08-04	3/4" - 16	1/2" - 14	74,0	31,0	22	27
A762509-08-06	3/4" - 16	3/8" - 19	68,0	31,0	19	22
A762509-08-08	3/4" - 16	1/2" - 14	77,0	34,0	22	27
A762509-10-08	7/8" - 14	3/8" - 19	76,0	36,5	22	27
A762509-10-12	7/8" - 14	1/2" - 14	88,5	39,5	27	32
A762509-12-12	1.1/16" - 12	3/4" - 14	91,0	42,0	27	32
A762509-12-16	1.1/16" - 12	1" - 11	98,0	46,0	36	41
A762509-16-12	1.5/16" - 12	3/4" - 14	98,0	46,0	36	41
A762509-16-16	1.5/16" - 12	1" - 11	98,0	46,0	36	41



**A762519**  
RUN TEE  
(SAE J514)  
METRIC ADJUSTABLE MALE  
(ISO 1179-3)

Trójnik asymetryczny  
nastawny  
JIC męski sztok 74°  
BSP męski z o-ringiem typu  
BOSS

Nr części	Gwint			Wymiary		
	F1 (UNF)	F2 (METR)	A	B	C	H1 H2
A762519-05-12	1/2" - 20	M12x1,5	68,5	31,5	27,0	14 19
A762519-06-16	9/16" - 18	M16x1,5	65,0	36,5	28,5	14 19
A762519-10-18	7/8" - 14	M18x1,5	76,0	41,5	36,5	22 27
A762519-12-22	1.1/16" - 12	M22x2,0	91,0	51,5	42,0	27 32
A762519-16-33	1.5/16" - 12	M33x2,0	98,0	59,0	46,0	36 41
A762519-20-42	1.5/8" - 12	M42x2,0	109,0	60,0	52,0	39 43
A762519-24-48	1.7/8" - 12	M48x2,0	120,0	67,0	59,0	43 52

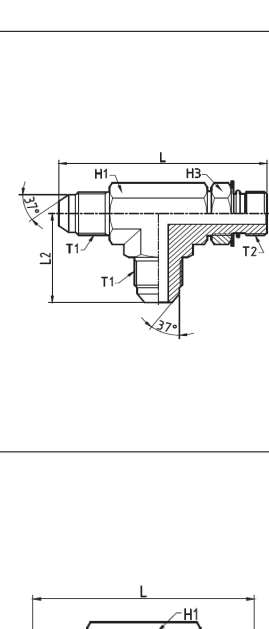

**A762523**  
RUN TEE BULKHEAD  
JIC MALE 74° CONE  
(SAE J514)

Trójnik symetryczny  
grozdowy  
JIC męski sztok 74°

Nr części	Gwint			Wymiary		
	T1 (UNF)	T2 (UNF)	L	L1	L2	H1 H3
A762523-04-04	7/16" - 20	7/16" - 20	65,0	40,5	24,5	14 16
A762523-05-05	1/2" - 20	7/16" - 20	67,0	41,0	26,0	14 16
A762523-06-06	9/16" - 18	9/16" - 18	73,6	45,5	27,5	14 19
A762523-08-08	3/4" - 16	3/4" - 16	88,0	53,5	34,5	19 24
A762523-10-10	7/8" - 14	7/8" - 14	100,0	60,5	39,5	22 27
A762523-12-12	1.1/16" - 12	1.1/16" - 12	113,0	68,0	45,0	27 32
A762523-16-16	1.5/16" - 12	1.5/16" - 12	120,0	71,0	49,0	36 38
A762523-20-20	1.5/8" - 12	1.5/8" - 12	134,0	79,0	55,0	41 50
A762523-24-24	1.7/8" - 12	1.7/8" - 12	146,0	87,0	59,0	50 55

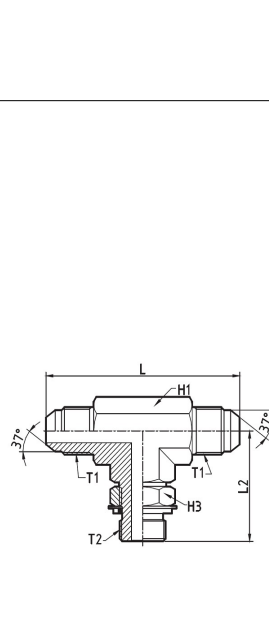

**A762528**  
NON  
JIC MALE  
(SAE J514)  
NPTF MALE  
(SAE J474)

Trójnik asymetryczny  
JIC męski  
NPTF męski

Nr części	Gwint			Wymiary		
	F1 (UNF)	F2 (NPTF)	A	B	C	H1
A762528-04-02	7/16" - 20	1/8" - 27	42,0	19,5	22,5	14
A762528-04-04	7/16" - 20	1/4" - 18	54,5	27,5	27,0	14
A762528-05-02	1/2" - 20	1/8" - 27	43,5	19,5	24,0	17
A762528-05-04	1/2" - 20	1/4" - 18	54,5	27,5	27,0	19
A762528-06-04	9/16" - 18	1/4" - 18	62,5	27,5	27,0	19
A762528-06-06	9/16" - 18	3/8" - 18	64,5	27,5	27,0	19
A762528-08-08	3/4" - 16	1/2" - 14	71,5	37,0	34,0	27
A762528-10-08	7/8" - 14	1/2" - 14	82,5	40,0	42,0	36
A762528-12-12	1.1/16" - 12	1.1/16" - 12	96,0	50,0	46,0	41
A762528-16-16	1.5/16" - 12	1.1/4" - 11/12	112,0	60,0	52,0	50

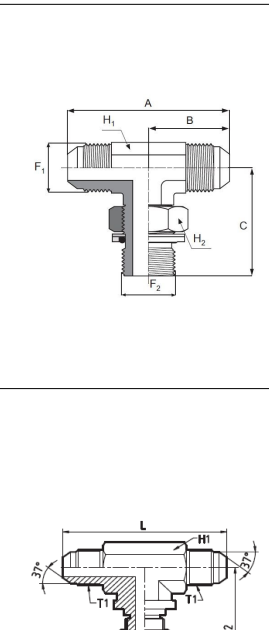

**A762531**  
RUN TEE ADJUSTABLE  
JIC MALE 74° CONE  
(SAE J514)  
BSP MALE O-RING  
BOSS TYPE  
(SAE J3026)

Trójnik asymetryczny  
nastawny  
JIC męski sztok 74°  
SAE męski z o-ringiem  
typu BOSS

Nr części	Gwint			Wymiary		
	T1 (UNF)	T2 (UNF)	L	L1	L2	H1 H3
A762531-04-04	7/16" - 20	7/16" - 20	65,0	40,5	24,5	14 16
A762531-05-05	1/2" - 20	7/16" - 20	67,0	41,0	26,0	14 16
A762531-06-06	9/16" - 18	9/16" - 18	73,6	45,5	27,5	14 19
A762531-08-08	3/4" - 16	3/4" - 16	88,0	53,5	34,5	19 24
A762531-10-10	7/8" - 14	7/8" - 14	100,0	60,5	39,5	22 27
A762531-12-12	1.1/16" - 12	1.1/16" - 12	113,0	68,0	45,0	27 32
A762531-16-16	1.5/16" - 12	1.5/16" - 12	120,0	71,0	49,0	36 38
A762531-20-20	1.5/8" - 12	1.5/8" - 12	134,0	79,0	55,0	41 50
A762531-24-24	1.7/8" - 12	1.7/8" - 12	146,0	87,0	59,0	50 55

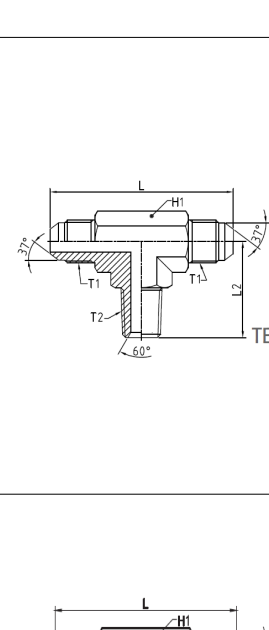

**A782507**  
BRANCH TEE  
JIC MALE 74° CONE  
(SAE J514)  
BSP MALE TAPERED  
(ISO 7)

Trójnik symetryczny  
JIC męski sztok 74°  
BSP męski gw. ścięty

Nr części	Gwint			Wymiary		
	T1 (UNF)	T2 (BSP)	L	L1	L2	H1 H2
A782507-04-02	7/16" - 20	1/8" - 28	45,0	21,0	12	11
A782507-05-02	1/2" - 20	1/8" - 28	50,0	23,0	14	14
A782507-06-04	9/16" - 18	1/4" - 19	54,0	27,0	14	14
A782507-08-06	3/4" - 16	3/8" - 19	63,0	31,0	19	19
A782507-10-08	7/8" - 14	1/2" - 14	73,0	37,0	27	22
A782507-12-12	1.1/16" - 12	3/4" - 14	84,0	45,0	36	27
A782507-16-16	1.5/16" - 12	1" - 11	92,0	46,0	40,5	36
A782507-20-20	1.5/8" - 12	1.1/4" - 11	104,0	54,0	41	41
A782507-24-24	1.7/8" - 12	1.1/2" - 11	118,0	60,0	50	50

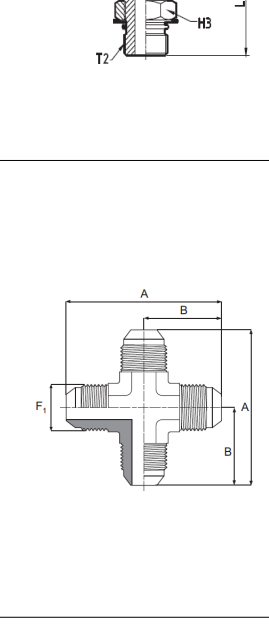

**A782509**  
BRANCH TEE  
JIC MALE 74° CONE  
(SAE J514)  
BSP MALE O-RING  
BOSS TYPE  
(ISO 1179-3)

Trójnik symetryczny  
nastawny  
JIC męski sztok 74°  
BSP męski z o-ringiem  
typu BOSS

Nr części	Gwint			Wymiary		
	T1 (UNF)	T2 (BSP)	L	L1	L2	H1 H3
A782509-04-04	7/16" - 20	1/4" - 19	50,0	31,5	14	19
A782509-04-06	7/16" - 20	3/8" - 19	57,0	36,5	19	22
A782509-05-04	1/2" - 20	1/4" - 19	50,0	31,5	14	19
A782509-05-06	1/2" - 20	3/8" - 19	57,0	36,5	19	22
A782509-06-06	9/16" - 18	3/8" - 19	56,0	36,5	19	22
A782509-06-08	9/16" - 18	1/2" - 14	62,0	43,0	22	27
A782509-08-08	3/4" - 16	3/8" - 19	63,0	36,5	19	22
A782509-08-06	3/4" - 16	1/2" - 14	68,0	43,0	22	27
A782509-10-08	7/8" - 14	3/8" - 19	73,0	39,5	22	27
A782509-10-12	7/8" - 14	1/2" - 14	79,0	49,0	27	32
A782509-12-12	1.1/16" - 12	3/4" - 14	84,0	49,0	27	32
A782509-12-16	1.1/16" - 12	1" - 11	92,0	52,0	36	41
A782509-16-12	1.5/16" - 12	3/4" - 14	92,0	52,0	36	41
A782509-16-16	1.5/16" - 12	1" - 11	92,0	52,0	36	41

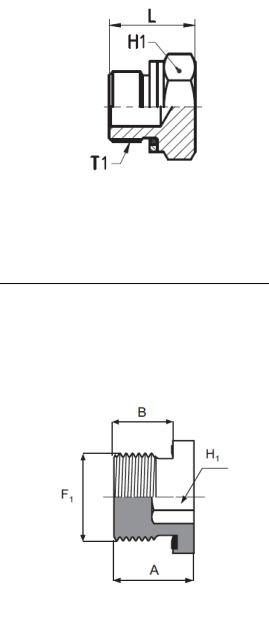

**A782519**  
BRANCH TEE  
JIC MALE 74° CONE  
(SAE J514)  
BSP MALE O-RING  
BOSS TYPE  
(SAE J3026)

Trójnik symetryczny  
JIC męski  
BSP męski sztok 74°

Nr części	Gwint			Wymiary		
	T1 (UNF)	T2 (UNF)	L	L1	L2	H1 H2
A782519-04-12	7/16" - 20	M12x1,5	54,0	27,0	31,5	14 16
A782519-05-12	1/2" - 20	M12x1,5	60,0	28,5	31,5	14 19
A782519-06-16	9/16" - 18	M16x1,5	67,0	27,5	36,5	14 16
A782519-08-18	3/4" - 16	M18x1,5	63,0	31,5	39,5	19 24
A782519-10-18	7/8" - 14	M18x1,5	73,0	36,5	41,5	22 27
A782519-12-22	1.1/16" - 12	M22x1,5	73,0	36,5	43,0	27 32
A782519-16-27	1.5/16" - 12	M27x2,0	92,0	46,0	55,0	36 38

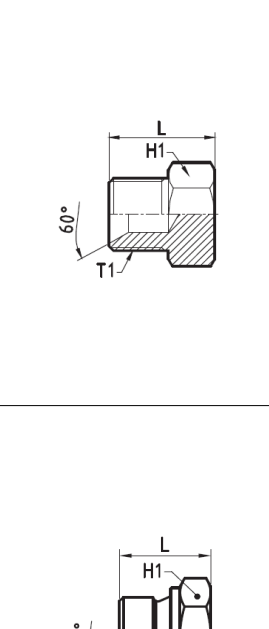

**A782523**  
BRANCH TEE BULKHEAD  
JIC MALE 74° CONE  
(SAE J514)

Trójnik symetryczny  
grozdowy  
JIC męski sztok 74°

Nr części	Gwint			Wymiary		
	T1 (UNF)	T2 (UNF)	L	L1	L2	H1 H3
A782523-04-04	7/16" - 20	7/16" - 20	49,0	40,5	14	16
A782523-05-05	1/2" - 20	7/16" - 20	52,0	41,0	14	16
A782523-06-06	9/16" - 18	9/16" - 18	55,0	46,0	14	19
A782523-08-08	3/4" - 16	3/4" - 16	69,0	53,5	19	24
A782523-10-10	7/8" - 14	7/8" - 14	79,0	60,5	22	27
A782523-12-12	1.1/16" - 12	1.1/16" - 12	90,0	68,0	27	32
A782523-16-16	1.5/16" - 12	1.5/8" - 12	98,0	71,0	35	38
A782523-20-20	1.5/8" - 12	1.5/8" - 12	110,0	79,0	41	50
A782523-24-24	1.7/8" - 12	1.7/8" - 12	118,0	87,0	50	55

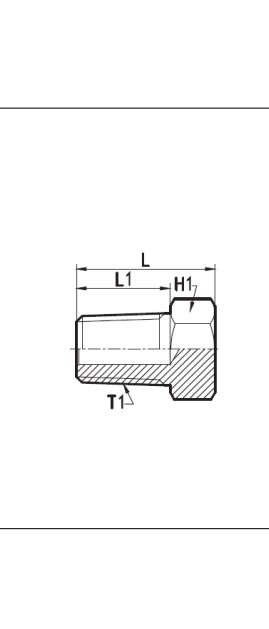

**A782528**  
BRANCH TEE  
JIC MALE 74° CONE  
(SAE J514)  
NPTF MALE O-RING SEAT  
(SAE J514)

Trójnik symetryczny  
JIC męski sztok 74°  
NPTF męski  
gniazdo sztokowe 60°

Nr części	Gwint			Wymiary		
	T1 (UNF)	T2 (NPTF)	L	L2	H1	
A782528-04-04	7/16" - 20	1/4" - 18	53,3	27,7	14	
A782528-05-04	1/2" - 20	1/4" - 18	53,3	27,7	14	
A782528-06-04	9/16" - 18	3/8" - 18	57,9	31,7	14	
A782528-08-08	3/4" - 16	1/2" - 14	67,6	37,3	22	
A782528-10-08	7/8" - 14	1/2" - 14	73,7	37,3	22	
A782528-12-12	1.1/16" - 12	3/4" - 14	84,3	40,4	27	
A782528-16-16	1.5/16" - 12	1" - 11,5	92,0	50,0	33	
A782528-20-20	1.5/8" - 12	1.1/4" - 11,5	104,7	60,5	41	

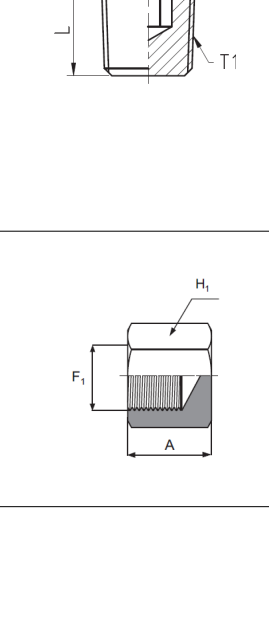

**A782531**  
BRANCH TEE ADJUSTABLE  
JIC MALE 74° CONE  
(SAE J514)  
BSP MALE O-RING  
BOSS TYPE  
(SAE J3026)

Trójnik symetryczny  
nastawny  
JIC męski sztok 74°  
SAE męski z o-ringiem  
typu BOSS

Nr części	Gwint			Wymiary		
	T1 (UNF)	T2 (UNF)	L	L1	L2	H1 H3
A782531-04-04	7/16" - 18	7/16" - 18	50,0	26,5	14	16
A782531-05-05	1/2" - 20	1/2" - 20	50,0	27,5	14	19
A782531-06-06	9/16" - 18	9/16" - 18	54,0	31,5	14	14
A782531-08-08	3/4" - 16	3/4" - 16	63,0	36,5	19	24
A782531-10-10	7/8" - 14	7/8" - 14	73,0	39,5	22	27
A782531-12-12	1.1/16" - 12	1.1/16" - 12	84,0	49,0	27	32
A782531-16-16	1.5/16" - 12	1.5/16" - 12	92,0	52,0	36	38



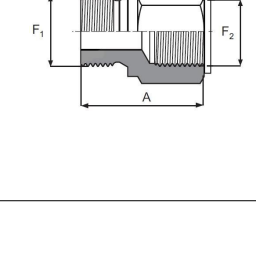

**AS20353**  
BSP MALE 60° CONE SEAT  
DIN PROFILE  
BSP PRESSURE  
GAUGE PORT

Nr części	Gwint		Wymiary	
	F1 (BSP)	F2 (BSP)	A	H1
AS20353-04-04	1/4" - 19	1/4" - 19	36,5	19
AS20353-04-02	1/4" - 19	1/8" - 28	39,5	22
AS20353-06-04	3/8" - 19	1/4" - 19	45,5	27
AS20353-06-08	3/8" - 19	1/2" - 14	54,0	32
AS20353-08-08	1/2" - 14	1/2" - 14	61,0	41
AS20353-12-08	3/4" - 14	1/2" - 14	67,0	50

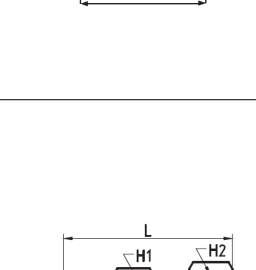

**AS25054**  
BSP MALE 60° CONE SEAT  
DIN PROFILE  
BSP FEMALE 60° CONE  
(ISO 228)

Nr części	Gwint		Wymiary	
	F1 (BSP)	F2 (BSP)	A	H1
AS25054-02-02	1/8" - 28	1/8" - 28	28,0	14
AS25054-04-04	1/4" - 19	1/8" - 28	31,0	19
AS25054-06-06	3/8" - 19	3/8" - 19	32,0	22
AS25054-08-08	1/2" - 14	3/8" - 19	40,0	27
AS25054-10-10	5/8" - 14	3/4" - 14	45,0	32
AS25054-12-12	3/4" - 14	3/4" - 14	48,0	36
AS25054-16-16	1" - 11	1" - 11	54,0	41



**AS25055**  
STRAIGHT ADAPTOR  
BSP MALE PARALLEL  
60° CONE SEAT  
BSP FEMALE 60° CONE  
(ISO 228)

Nr części	Gwint		Wymiary	
	T1 (BSP)	T2 (BSP)	L	H1
AS25055-04-04	1/4" - 19	1/4" - 19	36,0	19
AS25055-06-06	3/8" - 19	3/8" - 19	42,0	22
AS25055-08-08	1/2" - 14	1/2" - 14	45,0	27
AS25055-10-10	5/8" - 14	5/8" - 14	51,0	32
AS25055-12-12	3/4" - 14	3/4" - 14	54,0	36
AS25055-16-16	1" - 11	1" - 11	64,0	41
AS25055-20-20	1.1/4" - 11	1.1/4" - 11	72,0	44
AS25055-24-24	1.1/2" - 11	1.1/2" - 11	79,0	50

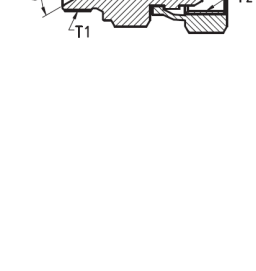

**AS20505D**  
STRAIGHT ADAPTOR  
BSP MALE PARALLEL  
60° CONE SEAT  
DIN PROFILE  
BSP FEMALE 60° CONE  
(ISO 228)

Nr części	Gwint		Wymiary	
	T1 (BSP)	T2 (BSP)	L	H1
AS20505-04-04D	1/4" - 19	1/4" - 19	38,0	19
AS20505-04-06D	1/4" - 19	3/8" - 19	39,5	19
AS20505-04-08D	1/4" - 19	1/2" - 14	42,0	22
AS20505-06-04D	3/8" - 19	1/4" - 19	38,0	22
AS20505-06-06D	3/8" - 19	3/8" - 19	40,5	22
AS20505-06-08D	3/8" - 19	1/2" - 14	43,5	27
AS20505-08-08D	1/2" - 14	1/2" - 14	46,0	27
AS20505-08-12D	1/2" - 14	3/4" - 14	51,0	32
AS20505-10-10D	5/8" - 14	5/8" - 14	51,0	30
AS20505-12-08D	3/4" - 14	1/2" - 14	49,0	32
AS20505-12-12D	3/4" - 14	3/4" - 14	54,0	32
AS20505-12-16D	3/4" - 14	1" - 11	55,0	35
AS20505-16-12D	1" - 11	3/4" - 14	59,5	41
AS20505-16-16D	1" - 11	1" - 11	64,0	41
AS20505-20-20D	1.1/4" - 11	1.1/4" - 11	67,0	50
AS20505-24-24D	1.1/2" - 11	1.1/2" - 11	78,0	55

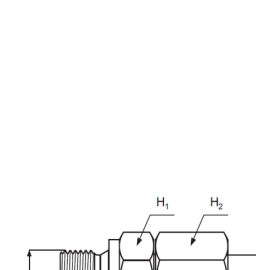

**AS25058**  
STRAIGHT ADAPTOR  
BSP MALE PARALLEL  
60° CONE SEAT  
DIN PROFILE  
BSP FEMALE 60° CONE  
WITH O-RING  
(ISO 228)

Nr części	Gwint		Wymiary	
	F1 (BSP)	F2 (BSP)	A	H1
AS25058-02-02	1/8" - 28	1/8" - 28	28,0	14
AS25058-04-04	1/4" - 19	1/4" - 19	38,0	19
AS25058-04-06	1/4" - 19	3/8" - 19	39,5	19
AS25058-04-08	1/4" - 19	1/2" - 14	42,0	22
AS25058-06-04	3/8" - 19	1/4" - 19	38,0	22
AS25058-06-06	3/8" - 19	3/8" - 19	40,5	22
AS25058-06-08	3/8" - 19	1/2" - 14	43,5	27
AS25058-08-06	1/2" - 14	1/2" - 14	46,0	27
AS25058-08-12	1/2" - 14	3/4" - 14	51,0	32
AS25058-10-10	5/8" - 14	5/8" - 14	51,0	30
AS25058-12-08	3/4" - 14	1/2" - 14	49,0	32
AS25058-12-12	3/4" - 14	3/4" - 14	54,0	32
AS25058-12-16	3/4" - 14	1" - 11	55,0	35
AS25058-16-12	1" - 11	3/4" - 14	59,5	41
AS25058-16-16	1" - 11	1" - 11	64,0	41
AS25058-16-20	1" - 11	1.1/4" - 11	62,0	41
AS25058-20-20	1.1/4" - 11	1.1/4" - 11	67,0	50
AS25058-24-24	1.1/2" - 11	1.1/2" - 11	78,0	55



**AS25058**  
STRAIGHT ADAPTOR  
BSP MALE PARALLEL  
60° CONE SEAT  
NPSM SWIVEL MALE  
(SAE J514)

Nr części	Gwint		Wymiary	
	T1 (BSP)	T2 (NPSM)	L	H1
AS25058-06-06	3/8" - 19	3/8" - 18	40,5	19
AS25058-08-08	1/2" - 14	1/2" - 14	46,0	22
AS25058-10-10	5/8" - 14	5/8" - 14	51,0	27
AS25058-12-12	3/4" - 14	3/4" - 14	54,0	32
AS25058-16-16	1" - 11	1" - 11	64,0	35
AS25058-20-20	1.1/4" - 11	1.1/4" - 11	72,0	40
AS25058-24-24	1.1/2" - 11	1.1/2" - 11	78,0	50

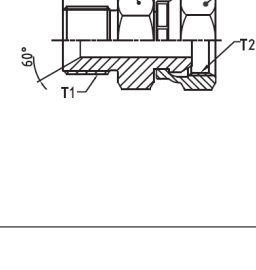

**AS20704**  
BSP MALE TAPPED  
(ISO 7)  
BSP FIXED FEMALE

Nr części	Gwint		Wymiary	
	F1 (BSP)	F2 (BSP)	A	H1
AS20704-02-02	1/8" - 28	1/8" - 28	23,0	10
AS20704-02-04	1/8" - 28	1/4" - 19	29,0	10
AS20704-02-06	1/8" - 28	3/8" - 19	33,0	10
AS20704-04-04	1/4" - 19	1/4" - 19	32,0	14
AS20704-04-06	1/4" - 19	3/8" - 19	34,0	14
AS20704-04-08	1/4" - 19	1/2" - 14	39,0	14
AS20704-06-02	3/8" - 19	1/8" - 28	19,5	12,5
AS20704-06-04	3/8" - 19	1/4" - 19	21,0	14,0
AS20704-06-06	3/8" - 19	3/8" - 19	32,0	14,0
AS20704-06-08	3/8" - 19	1/2" - 14	39,0	15,0
AS20704-08-02	1/2" - 14	1/8" - 28	27,0	19,0
AS20704-08-04	1/2" - 14	1/4" - 19	27,0	19,0
AS20704-08-06	1/2" - 14	3/8" - 19	41,0	19,5
AS20704-08-12	1/2" - 14	3/4" - 14	45,0	20,0
AS20704-10-16	5/8" - 14	1" - 11	51,0	19,0
AS20704-12-16	3/4" - 14	1" - 11	50,0	20,0
AS20704-16-16	1" - 11	1" - 11	60,0	24,0
AS20704-16-12	1" - 11	3/4" - 14	33,0	23,0
AS20704-16-16	1" - 11	1" - 11	56,0	24,0
AS20704-16-20	1" - 11	1.1/4" - 11	57,5	24,0
AS20704-20-12	1.1/4" - 11	3/4" - 14	36,0	24,0
AS20704-20-16	1.1/4" - 11	1" - 11	36,0	24,0
AS20704-20-24	1.1/4" - 11	1.1/2" - 11	63,0	25,0
AS20704-24-16	1.1/2" - 11	1" - 11	39,5	26,0
AS20704-24-20	1.1/2" - 11	1.1/4" - 11	37,0	25,0
AS20704-24-24	1.1/2" - 11	1.1/4" - 11	37,0	26,0
AS20704-32-20	2" - 11	1.1/4" - 11	62,0	26,0
AS20704-32-24	2" - 11	2" - 11	64,0	26,0



**AS20705**  
STRAIGHT ADAPTOR  
BSP MALE PARALLEL  
60° CONE SEAT  
BSP MALE TAPPED  
(ISO 7)

Nr części	Gwint		Wymiary	
	T1 (BSP)	T2 (BSP)	L	H1
AS20705-04-04	1/4" - 19	1/4" - 19	37,0	14
AS20705-06-06	3/8" - 19	3/8" - 19	43,0	19
AS20705-06-08	3/8" - 19	1/2" - 14	46,0	22
AS20705-08-06	1/2" - 14	3/8" - 19	46,0	22
AS20705-08-08	1/2" - 14	1/2" - 14	49,0	22
AS20705-12-12	3/4" - 14	3/4" - 14	56,0	32
AS20705-16-16	1" - 11	1" - 11	66,0	35
AS20705-20-20	1.1/4" - 11	1.1/4" - 11	72,0	44
AS20705-24-24	1.1/2" - 11	1.1/2" - 11	80,0	50

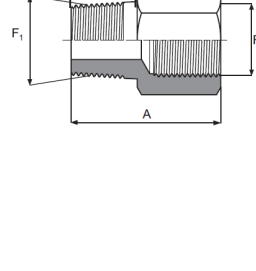

**AS53057**  
45° ELBOW ADAPTOR  
BSP MALE PARALLEL  
60° CONE SEAT  
BSP MALE TAPPED  
(ISO 7)

Nr części	Gwint		Wymiary	
	T1 (BSP)	T2 (BSP)	L1	L2
AS53057-04-04	1/4" - 19	1/4" - 19	21,0	21,0
AS53057-06-06	3/8" - 19	3/8" - 19	28,0	28,0
AS53057-08-08	1/2" - 14	1/2" - 14	28,0	31,0
AS53057-12-12	3/4" - 14	3/4" - 14	33,0	31,5
AS53057-16-16	1" - 11	1" - 11	38,0	41,0
AS53057-20-20	1.1/4" - 11	1.1/4" - 11	46,0	44,0
AS53057-24-24	1.1/2" - 11	1.1/2" - 11	47,0	48,0
AS53057-32-32	2" - 11	2" - 11	56,0	55,0



**AS20704**  
BSP MALE TAPPED  
(ISO 7)  
BSP FIXED FEMALE

Nr części	Gwint		Wymiary	
	F1 (BSP)	F2 (BSP)	A	H1
AS20704-08-12	1/2" - 14	3/4" - 14	45,0	20,0
AS20704-10-16	5/8" - 14	1" - 11	51,0	19,0
AS20704-12-16	3/4" - 14	1" - 11	50,0	19,0
AS20704-12-06	3/4" - 14	3/8" - 19	29,0	19,5
AS20704-12-08	3/4" - 14	1/2" - 14	29,0	19,5
AS20704-12-10	3/4" - 14	5/8" - 14	29,0	19,5
AS20704-12-12	3/4" - 14	3/4" - 14	33,0	19,5
AS20704-12-14	3/4" - 14	1" - 11	33,0	19,5
AS20704-12-16	3/4" - 14	1" - 11	33,0	19,5
AS20704-12-18	3/4" - 14	1" - 11	33,0	19,5
AS20704-12-20	3/4" - 14	1" - 11	33,0	19,5
AS20704-12-22	3/4" - 14	1" - 11	33,0	19,5
AS20704-12-24	3/4" - 14	1" - 11	33,0	19,5
AS20704-12-26	3/4" - 14	1" - 11	33,0	19,5
AS20704-12-28	3/4" - 14	1" - 11	33,0	19,5
AS20704-12-30	3/4" - 14	1" - 11	33,0	19,5
AS20704-12-32	3/4" - 14	1" - 11	33,0	19,5
AS20704-12-34	3/4" - 14	1" - 11	33,0	19,5
AS20704-12-36	3/4" - 14	1" - 11	33,0	19,5
AS20704-12-38	3/4" - 14	1" - 11	33,0	19,5
AS20704-12-40	3/4" - 14	1" - 11	33,0	19,5
AS20704-12-42	3/4" - 14	1" - 11	33,0	19,5
AS20704-12-44	3/4" - 14	1" - 11	33,0	19,5
AS20704-12-46	3/4" - 14	1" - 11	33,0	19,5
AS20704-12-48	3/4" - 14	1" - 11	33,0	19,5
AS20704-12-50	3/4" - 14	1" - 11	33,0	19,5
AS20704-12-52	3/4" - 14	1" - 11	33,0	19,5
AS20704-12-54	3/4" - 14	1" - 11	33,0	19,5
AS20704-12-56	3/4" - 14			



**A422400**  
SLEEVE ORFIS  
(SAE J1453)

Nr części	Wymiar węża zew.	Gwint		Wymiary	
		D	T1 (UNF/UN)	L	H1
A422400-06-04	6	9/16"	-18	9,5	16
A422400-10-06	10	1 1/16"	-18	9,5	16
A422400-12-06	12	1 1/16"	-16	9,5	16
A422400-16-10	16	1"	-14	10,5	16
A422400-20-12	20	2"	1 1/16"	-12	14,0
A422400-25-16	25	2 1/2"	1 1/16"	-12	15,5
A422400-30-20	30	3"	1 1/16"	-12	15,5
A422400-38-24	38	3 1/2"	1 1/16"	-12	15,5

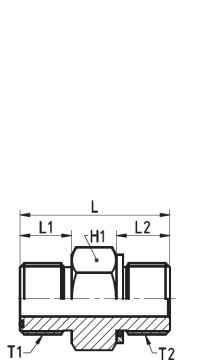

**A432400**  
NUT ORFIS  
(SAE J1453)

Nr części	Wymiar węża zew.	Gwint		Wymiary	
		D	T1 (UNF/UN)	L	H2
A432400-06-04	6	9/16"	-18	14,5	17
A432400-10-06	10	1 1/16"	-16	17,0	22
A432400-12-08	12	1 1/16"	-16	21,0	24
A432400-16-10	16	1"	-14	23,5	30
A432400-20-12	20	1 1/16"	-12	26,0	36
A432400-25-16	25	1 1/16"	-12	27,0	41
A432400-30-20	30	1 1/16"	-12	28,0	50
A432400-38-24	38	2"	-12	28,0	60



**A502403**  
STRAIGHT ADAPTOR ORFIS MALE  
(SAE J1453)  
BSP OR BOSS MALE (ISO 1549)

Nr części	Gwint		Wymiary		
	T1 (UNF/UN)	T2 (BSPP)	L	L1	H1
A502403-04-04	9/16" -18	1/4" -19	30,0	10,0	12,0
A502403-04-06	9/16" -18	3/8" -19	31,0	10,0	12,0
A502403-06-04	1 1/16" -16	1/4" -19	32,5	11,0	12,0
A502403-06-06	1 1/16" -16	3/8" -19	32,5	11,0	12,0
A502403-08-06	1 1/16" -16	1/2" -14	34,5	11,0	12,0
A502403-08-08	1 1/16" -16	3/8" -19	34,5	11,0	14,0
A502403-08-10	1 1/16" -16	1/2" -14	37,0	13,0	14,0
A502403-08-12	1 1/16" -16	3/4" -14	41,0	13,0	16,0
A502403-10-12	1" -14	1/2" -14	43,5	15,5	16,0
A502403-12-12	1 3/16" -12	3/4" -14	45,0	17,0	16,0
A502403-12-16	1 3/16" -12	1" -11	49,0	17,0	18,0
A502403-16-16	1 7/16" -12	1" -11	59,0	17,5	18,0
A502403-16-20	1 7/16" -12	1 1/4" -11	54,0	17,5	20,0
A502403-20-20	1 1 1/16" -12	1 1/4" -11	51,5	17,5	20,0
A502403-24-24	2" -12	1 1/2" -11	55,5	17,5	22,0



**A502419**  
STRAIGHT ADAPTOR ORFIS MALE  
(SAE J1453)  
METRIC MALE (ISO 1549)

Nr części	Gwint		Wymiary		
	T1 (UNF/UN)	T2 (METRIC)	L	L1	H1
A502419-04-10	9/16" -18	10 x 1	26,0	10,0	9,0
A502419-04-12	9/16" -18	12 x 1,5	26,0	10,0	11,0
A502419-06-14	1 1/16" -16	14 x 1,5	31,0	11,0	11,0
A502419-06-16	1 1/16" -16	16 x 1,5	33,0	11,0	12,5
A502419-08-18	1 3/16" -16	18 x 1,5	38,0	13,0	14,0
A502419-08-22	1 3/16" -16	22 x 1,5	40,0	13,0	15,0
A502419-10-12	1" -14	22 x 1,5	40,5	15,5	16,0
A502419-10-17	1" -14	27 x 2	48,0	15,5	18,5
A502419-12-27	1 3/16" -12	27 x 2	47,5	17,0	18,5
A502419-12-33	1 3/16" -12	33 x 2	49,0	17,0	18,5
A502419-16-33	1 7/16" -12	33 x 2	50,0	17,5	18,5
A502419-16-42	1 7/16" -12	42 x 2	52,0	17,5	19,0
A502419-20-42	1 1 1/16" -12	42 x 2	52,0	17,5	19,0
A502419-20-48	1 1 1/16" -12	48 x 2	56,0	17,5	22,0
A502419-24-48	2" -12	48 x 2	55,5	17,5	22,0

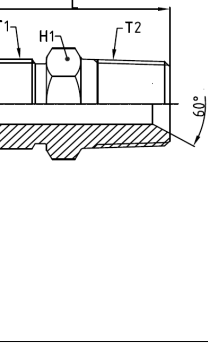

**A502424**  
STRAIGHT ADAPTOR ORFIS MALE  
(SAE J1453)

Nr części	Gwint		Wymiary		
	T1 (UNF/UN)	T2 (UNF/UN)	L	L1	H1
A502424-04-04	9/16" -18	9/16" -18	27,5	10,0	16
A502424-06-06	1 1/16" -16	1 1/16" -16	31,0	11,0	19
A502424-08-08	1 3/16" -16	1 3/16" -16	35,5	13,0	22
A502424-10-10	1" -14	1" -14	42,5	15,5	27
A502424-12-12	1 3/16" -12	1 3/16" -12	47,0	17,0	32
A502424-12-16	1 3/16" -12	1 3/16" -12	48,0	17,5	38
A502424-16-16	1 7/16" -12	1 7/16" -12	49,0	17,5	38
A502424-16-20	1 7/16" -12	1 7/16" -12	50,0	17,5	40
A502424-20-20	1 1 1/16" -12	1 1 1/16" -12	51,5	17,5	46
A502424-24-24	2" -12	2" -12	53,0	17,5	55



**A502425**  
STRAIGHT ADAPTOR ORFIS MALE  
(SAE J1453)  
3/8" MALE 7/8" CONE (SAE J514)

Nr części	Gwint		Wymiary		
	T1 (UNF/UN)	T2 (UNF)	L	L1	H1
A502425-04-04	9/16" -18	7/16" -20	32,5	10,0	15,0
A502425-06-06	1 1/16" -16	9/16" -18	35,5	11,0	16,0
A502425-08-08	1 3/16" -16	3/4" -16	40,5	13,0	18,0
A502425-10-10	1" -14	7/8" -14	47,0	15,5	21,0
A502425-12-12	1 3/16" -12	1 1/16" -12	52,5	17,0	24,0
A502425-16-16	1 7/16" -12	1 5/16" -12	56,0	17,5	25,0
A502425-20-20	1 1 1/16" -12	1 5/8" -12	60,0	17,5	28,0



**A502427**  
STRAIGHT ADAPTOR ORFIS MALE  
(SAE J1453)

Nr części	Gwint		Wymiary		
	T1 (UNF/UN)	T2 (UNF/UN)	L	L1	H1
A502427-04-04	9/16" -18	9/16" -18	48,5	10,0	31,5
A502427-06-06	1 1/16" -16	1 1/16" -16	54,0	11,0	34,0
A502427-08-08	1 3/16" -16	1 3/16" -16	58,5	13,0	36,5
A502427-10-10	1" -14	1" -14	66,5	15,5	40,5
A502427-12-12	1 3/16" -12	1 3/16" -12	69,0	17,0	41,5
A502427-16-16	1 7/16" -12	1 7/16" -12	70,0	17,5	42,0
A502427-20-20	1 1 1/16" -12	1 1 1/16" -12	70,0	17,5	42,0
A502427-24-24	2" -12	2" -12	70,0	17,5	42,0

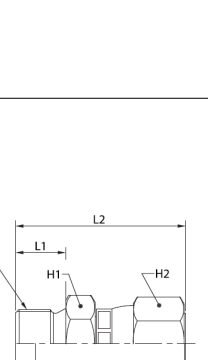

**A502428**  
STRAIGHT ADAPTOR ORFIS MALE  
(SAE J1453)  
NPTF MALE 60° CONE SEAT (SAE J514)

Nr części	Gwint		Wymiary		
	T1 (UNF/UN)	T2 (NPTF)	L	L1	H1
A502428-04-04	9/16" -18	1/4" -18	32,0	16	
A502428-04-06	9/16" -18	3/8" -18	32,0	19	
A502428-06-04	1 1/16" -16	1/4" -18	34,0	19	
A502428-06-06	1 1/16" -16	3/8" -18	34,0	19	
A502428-06-08	1 1/16" -16	1/2" -14	39,4	24	
A502428-08-06	1 3/16" -16	3/8" -18	36,8	22	
A502428-08-08	1 3/16" -16	1/2" -14	41,7	22	
A502428-10-08	1" -14	1/2" -14	46,2	27	
A502428-12-12	1 3/16" -12	3/4" -14	49,3	32	
A502428-16-16	1 7/16" -12	1" -11,5	55,6	38	
A502428-20-20	1 1 1/16" -12	1" -11,5	58,4	46	

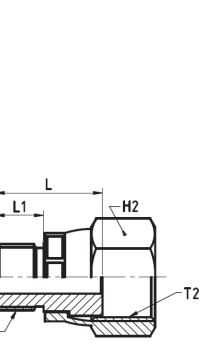

**A502429**  
ORFIS MALE - ORFIS LONG TYPE MALE  
(SAE J1453)

Nr części	Gwint		Wymiary		
	F1 (UNF/UN)	F2 (UNF/UN)	A	B	C
A502429-04-04	9/16" -18	9/16" -18	48,0	31,5	22
A502429-06-06	1 1/16" -16	1 1/16" -16	53,0	31,0	27
A502429-08-08	1 3/16" -16	1 3/16" -16	58,0	33,0	30
A502429-10-10	1" -14	1" -14	66,5	35,5	32
A502429-12-12	1 3/16" -12	1 3/16" -12	69,0	37,0	35
A502429-16-16	1 7/16" -12	1 7/16" -12	70,0	37,5	40
A502429-20-20	1 1 1/16" -12	1 1 1/16" -12	70,0	37,5	42,0
A502429-24-24	2" -12	2" -12	70,0	37,5	42,0

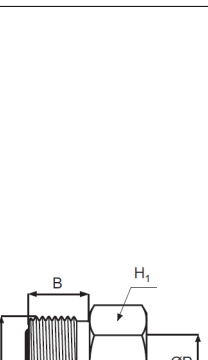

**A502430**  
STRAIGHT ADAPTOR ORFIS MALE  
(SAE J1453)  
SAE MALE O-RING BOSS TYPE (SAE J1453)

Nr części	Gwint		Wymiary		
	T1 (UNF/UN)	T2 (UNF)	L	L1	H1
A502430-04-04	9/16" -18	7/16" -20	28,5	10,0	9,5
A502430-04-06	9/16" -18	9/16" -18	30,5	10,0	12,0
A502430-06-06	1 1/16" -16	9/16" -18	32,0	11,0	10,0
A502430-08-08	1 3/16" -16	3/4" -16	37,5	13,0	11,0
A502430-08-10	1 3/16" -16	9/16" -18	38,5	13,0	11,5
A502430-08-12	1 3/16" -16	7/8" -14	40,5	13,0	16,0
A502430-10-08	1" -14	3/4" -16	45,0	15,5	14,0
A502430-10-10	1" -14	7/8" -14	43,0	15,5	13,0
A502430-12-12	1 3/16" -12	1 1/16" -12	48,5	17,0	15,5
A502430-12-16	1 3/16" -12	1 5/16" -12	50,0	17,0	18,5
A502430-16-16	1 7/16" -12	1 5/16" -12	54,0	17,5	18,5
A502430-16-20	1 7/16" -12	1 5/8" -12	52,0	17,5	18,5
A502430-20-20	1 1 1/16" -12	1 5/8" -12	52,5	17,5	18,5
A502430-24-24	2" -12	1 7/8" -12	54,0	17,5	18,5



**A502930**  
STRAIGHT ADAPTOR ORFIS MALE  
(SAE J1453)  
SAE MALE O-RING BOSS TYPE (SAE J1453)

Nr części	Gwint		Wymiary		
	T1 (UNF/UN)	T2 (UNF)	L	L1	H1
A502930-04-04	9/16" -18	7/16" -20	52,5	34,0	9,5
A502930-06-06	1 1/16" -16	9/16" -18	57,5	37,0	10,0
A502930-08-08	1 3/16" -16	3/4" -16	68,0	44,5	11,5
A502930-10-10	1" -14	7/8" -14	79,0	52,5	13,0
A502930-12-12	1 3/16" -12	1 1/16" -12	95,5	64,0	15,5
A502930-16-16	1 7/16" -12	1 5/16" -12	105,0	73,0	15,5
A502930-20-20	1 1 1/16" -12	1 5/8" -12	121,0	86,5	15,5
A502930-24-24	2" -12	1 7/8" -12	133,5	97,0	15,5

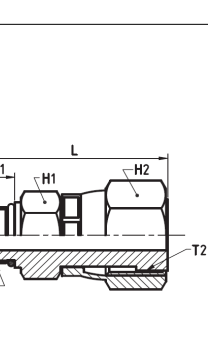

**A502524**  
BSP MALE 60° CONE SEAT  
DIN PROFILE (SAE J1453)  
ORFIS SWIVEL FEMALE (SAE J1453) (ISO 6434-3)

Nr części	Gwint		Wymiary		
	T1 (BSPP)	T2 (UNF/UN)	L1	L2	H1
A502524-04-04	1/4" -19	9/16" -18	11,0	34,5	19
A502524-06-06	3/8" -19	1 1/16" -16	12,0	42,5	22
A502524-08-08	3/8" -19	1 3/16" -16	16,0	40,5	22
A502524-08-10	1/2" -14	1 1/16" -16	14,0	41,5	22
A502524-08-12	1/2" -14	1 3/16" -16	14,0	44,5	27
A502524-08-10	1/2" -14	1" -14	14,0	50,5	27
A502524-12-12	3/4" -14	1 3/16" -12	16,0	56,5	32
A502524-16-16	1" -11	1 7/16" -12	19,0	62,0	41

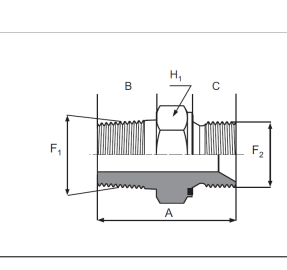

**A500719**  
BSP MALE TAPERED  
(ISO 7)  
METRIC MALE  
LIGHT TYPE  
BSP męski stały  
METRYCZNY męski

Nr części	Gwint		Wymiary		
	F1 (BSP)	F2 (METR)	A	B	H1
A500719-06-22	3/8" - 19	M22x1,5	39,0	15,0	15,0
A500719-08-22	1/2" - 14	M22x1,5	43,0	19,0	14,5

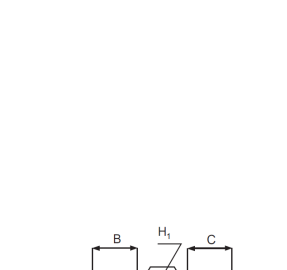

**A501010**  
METRIC MALE  
(ISO 6149-2)  
BSP FULL LIGHT TYPE  
60° gwint zewnętrzny  
DIN 9130

Nr części	Gwint		Wymiary		
	F1 (METR)	F2 (METR)	A	B	H1
A501010-12-12	M12x1,5	M12x1,5	34,0	12,0	12,0
A501010-12-14	M12x1,5	M14x1,5	34,0	12,0	12,0
A501010-14-14	M14x1,5	M14x1,5	34,0	12,0	12,0
A501010-14-16	M14x1,5	M16x1,5	34,0	12,0	12,0
A501010-16-18	M16x1,5	M18x1,5	35,0	12,0	12,0
A501010-18-18	M18x1,5	M18x1,5	36,0	12,0	12,0
A501010-22-22	M22x1,5	M22x1,5	40,0	14,0	14,0
A501010-26-26	M26x1,5	M26x1,5	47,0	16,0	16,0
A501010-30-30	M30x1,5	M30x1,5	48,0	16,0	16,0
A501010-38-38	M38x1,5	M38x1,5	50,0	16,0	16,0
A501010-45-45	M45x1,5	M45x1,5	52,0	16,0	16,0
A501010-52-52	M52x1,5	M52x1,5	43,0	14,0	14,0
A501010-65-65	M65x2,0	M65x2,0	48,0	17,0	17,0

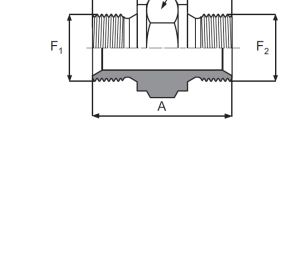

**A511919**  
METRIC MALE  
(ISO 6149-1)  
METRYCZNY żeński

Nr części	Gwint		Wymiary	
	F1 (METR)	F2 (METR)	A	H1
A511919-22-22	M22x1,5	M22x1,5	38,0	27

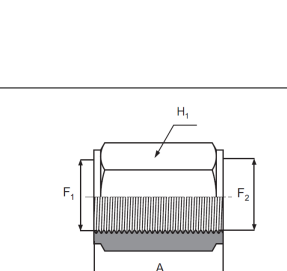

**A520714**  
BSP MALE TAPERED  
(ISO 6149-2)  
METRIC FIXED FEMALE  
BSP męski stały  
METRYCZNY żeński

Nr części	Gwint		Wymiary		
	F1 (BSP)	F2 (METR)	A	B	H1
A520714-06-16	3/8" - 19	M16x1,5	30,0	15,0	21
A520714-08-22	3/8" - 19	M22x1,5	38,5	15,5	26
A520714-08-16	1/2" - 14	M16x1,5	22,5	15,5	22
A520714-08-22	1/2" - 14	M22x1,5	28,5	19,0	28

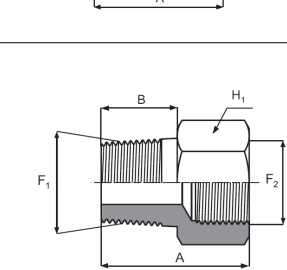

**A521904**  
METRIC MALE  
(ISO 6149-2)  
BSP FIXED FEMALE  
BSP stały żeński

Nr części	Gwint		Wymiary		
	F1 (METR)	F2 (BSP)	A	B	H1
A521904-16-04	M16x1,5	1/4" - 19	28,5	12,0	16
A521904-22-04	M22x1,5	1/4" - 19	21,0	12,0	19
A521904-16-06	M16x1,5	3/8" - 19	20,0	12,0	21
A521904-22-06	M22x1,5	3/8" - 19	22,0	13,0	26
A521904-16-08	M16x1,5	1/2" - 14	36,0	12,0	22
A521904-22-08	M22x1,5	1/2" - 14	36,0	14,0	26

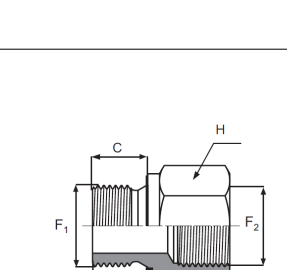

**A521914**  
METRIC MALE  
(ISO 6149-2)  
METRIC FIXED FEMALE  
METRYCZNY męski  
METRYCZNY sily żeński

Nr części	Gwint		Wymiary		
	F1 (METR)	F2 (METR)	A	B	H
A521914-16-22	M16x1,5	M22x1,5	31,5	12,0	26
A521914-22-22	M22x1,5	M16x1,5	21,0	12,0	21

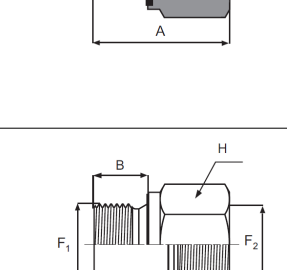

**A521935**  
METRIC MALE  
(ISO 6149-1)  
NPT FEMALE  
METRYCZNY męski  
NPT żeński

Nr części	Gwint		Wymiary		
	F1 (NPT)	F2 (METR)	A	B	H
A521935-16-04	1/4" - 18	M16x1,5	31,5	12,0	21
A521935-22-04	1/4" - 18	M22x1,5	24,5	11,0	21
A521935-26-06	3/8" - 18	M22x1,5	24,5	11,0	26

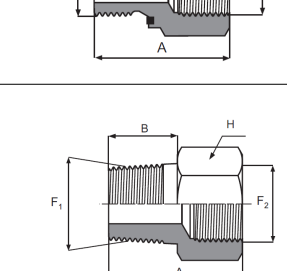

**A401100**  
METRIC MALE PLUG  
LIGHT TYPE  
(DIN 2353)  
METRYCZNE ścienne męskie  
typ 0400

Nr części	Gwint	Ciężnienie robocze	Wymiary		
			F (METR)	W.P. (bar)	P A H
A401100-06	M12x1,5	315	6,0	7,0	12
A401100-08	M14x1,5	315	8,0	8,0	14
A401100-10	M16x1,5	315	10,0	9,0	17
A401100-12	M18x1,5	315	12,0	10,0	19
A401100-15	M22x1,5	315	15,0	11,0	24
A401100-18	M26x1,5	160	18,0	11,5	17
A401100-22	M30x2,0	160	22,0	13,5	32
A401100-28	M36x2,0	160	28,0	14,5	41
A401100-35	M45x2,0	160	35,0	14,5	46
A401100-42	M52x2,0	160	42,0	16,0	55

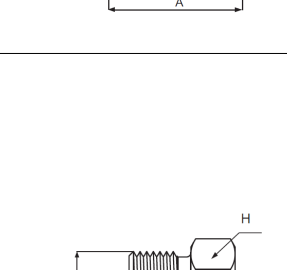

**A401200**  
METRIC MALE PLUG  
HEAVY TYPE  
(DIN 2353)  
METRYCZNE ścienne męskie  
typ 0400

Nr części	Gwint	Ciężnienie robocze	Wymiary		
			F (METR)	W.P. (bar)	P A H
A401200-06	M12x1,5	630	6,0	11,0	14
A401200-08	M14x1,5	630	8,0	13,0	17
A401200-10	M16x1,5	630	10,0	12,5	19
A401200-12	M20x1,5	630	12,0	14,5	22
A401200-14	M22x1,5	630	14,0	16,0	24
A401200-16	M24x1,5	400	16,0	15,5	27
A401200-20	M30x2,0	400	20,0	17,5	32
A401200-25	M36x2,0	400	25,0	20,0	41
A401200-30	M42x2,0	400	30,0	20,5	46
A401200-38	M52x2,0	315	38,0	23,0	55

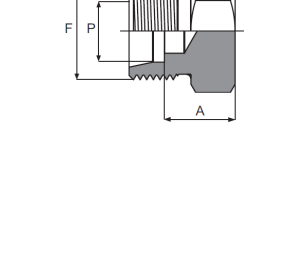

**A411500**  
METRIC FEMALE PLUG  
LIGHT TYPE  
(DIN 2353)  
METRYCZNE ścienne żeńskie  
typ 0400

Nr części	Gwint	Ciężnienie robocze	Wymiary		
			F (METR)	W.P. (bar)	P A H
A411500-06	M12x1,5	315	6,0	13,5	14
A411500-08	M14x1,5	315	8,0	14,0	17
A411500-10	M16x1,5	315	10,0	18,0	19
A411500-12	M18x1,5	315	12,0	19,0	22
A411500-15-22	M22x1,5	315	15,0	19,0	27
A411500-16-26	M26x1,5	315	18,0	20,0	32
A411500-22-30	M30x2,0	160	22,0	20,5	36
A411500-28-36	M36x2,0	160	28,0	20,5	41
A411500-35-45	M45x2,0	160	35,0	20,5	50
A411500-42-52	M52x2,0	160	42,0	20,5	60

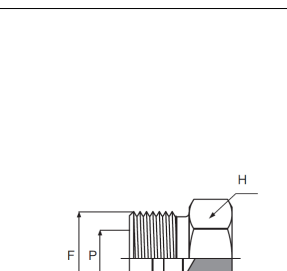

**A411600**  
METRIC FEMALE PLUG  
HEAVY TYPE  
(DIN 2353)  
METRYCZNE ścienne żeńskie  
typ 0400

Nr części	Gwint	Ciężnienie robocze	Wymiary		
			F (METR)	W.P. (bar)	P A H
A411600-06	M12x1,5	630	6,0	13,5	17
A411600-08	M14x1,5	630	8,0	14,0	19
A411600-10	M16x1,5	630	10,0	18,0	22
A411600-12	M18x1,5	630	12,0	19,0	24
A411600-14-22	M22x1,5	630	14,0	19,0	27
A411600-16-24	M24x1,5	400	16,0	20,0	30
A411600-20-30	M30x2,0	400	20,0	20,0	36
A411600-25-36	M36x2,0	400	25,0	20,5	46
A411600-30-42	M42x2,0	400	30,0	20,5	50
A411600-38-52	M52x2,0	315	38,0	20,5	60

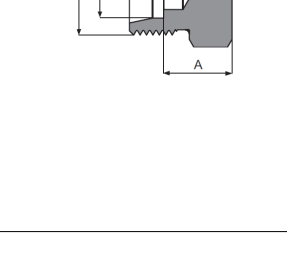

**A421100**  
BITE RING  
LIGHT TYPE  
(DIN 2353)  
Pierścieni zakasowy  
typ 0400

Nr części	Gwint	Ciężnienie robocze	Wymiary		
			F (METR)	W.P. (bar)	P A H
A421100-06-12	M12x1,5	315	6,0	9,5	10,0
A421100-08-14	M14x1,5	315	8,0	9,5	12,0
A421100-10-16	M16x1,5	315	10,0	10,0	14,0
A421100-12-18	M18x1,5	315	12,0	10,0	16,0
A421100-15-22	M22x1,5	315	15,0	10,0	20,0
A421100-16-26	M26x1,5	160	18,0	10,0	23,0
A421100-22-30	M30x2,0	160	22,0	10,5	27,0
A421100-28-36	M36x2,0	160	28,0	11,0	33,0
A421100-35-45	M45x2,0	160	35,0	13,0	41,0
A421100-42-52	M52x2,0	160	42,0	13,0	48,0

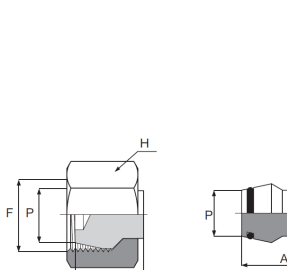

**A421000**  
BITE RING  
HEAVY TYPE  
(DIN 2353)  
Pierścieni zakasowy  
typ 0400

Nr części	Gwint	Ciężnienie robocze	Wymiary		
			F (METR)	W.P. (bar)	P A H
A421000-06-14	M12x1,5	630	6,0	9,5	10,0
A421000-08-16	M14x1,5	630	8,0	9,5	12,0
A421000-10-18	M16x1,5	630	10,0	10,0	14,0
A421000-12-20	M18x1,5	630	12,0	10,0	16,0
A421000-14-22	M22x1,5	630	14,0	10,0	19,0
A421000-16-24	M24x1,5	400	16,0	10,5	21,0
A421000-20-30	M30x2,0	400	20,0	10,5	27,0
A421000-25-36	M36x2,0	400	25,0	12,0	32,0
A421000-30-42	M42x2,0	400	30,0	13,0	38,0
A421000-38-52	M52x2,0	315	38,0	13,0	48,0

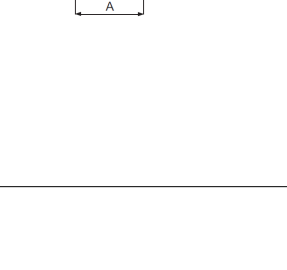

**A421100B4**  
BITE RING B4  
LIGHT TYPE  
(DIN 2353)  
Pierścieni zakasowy B4  
typ 0400

Nr części	Gwint	Ciężnienie robocze	Wymiary		
			F (METR)	W.P. (bar)	P A D
A421100-06-12B4	M12x1,5	315	6,0	9,5	10,0
A421100-08-14B4	M14x1,5	315	8,0	9,5	12,0
A421100-10-16B4	M16x1,5	315	10,0	10,0	14,0
A421100-12-18B4	M18x1,5	315	12,0	10,0	16,0
A421100-15-22B4	M22x1,5	315	15,0	10,0	20,0
A421100-16-26B4	M26x1,5	160	18,0	10,0	23,0
A421100-22-30B4	M30x2,0	160	22,0	10,5	27,0
A421100-28-36B4	M36x2,0	160	28,0	11,0	33,0
A421100-35-45B4	M45x2,0	160	35,0	13,0	41,0
A421100-42-52B4	M52x2,0	160	42,0	13,0	48,0

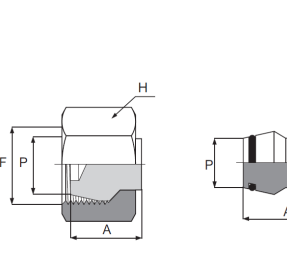

**A421200**  
BITE RING  
HEAVY TYPE  
(DIN 2353)  
Pierścieni zakasowy  
typ 0400

Nr części	Gwint	Ciężnienie robocze	Wymiary		
			F (METR)	W.P. (bar)	P A D
A421200-06-14	M12x1,5	630	6,0	9,5	10,0
A421200-08-16	M14x1,5	630	8,0	9,5	12,0
A421200-10-18	M16x1,5	630	10,0	10,0	14,0
A421200-12-20	M18x1,5	630	12,0	10,0	16,0
A421200-14-22	M22x1,5	630	14,0	10,0	19,0
A421200-16-24	M24x1,5	400	16,0	10,5	21,0
A421200-20-30	M30x2,0	400	20,0	10,5	27,0
A421200-					

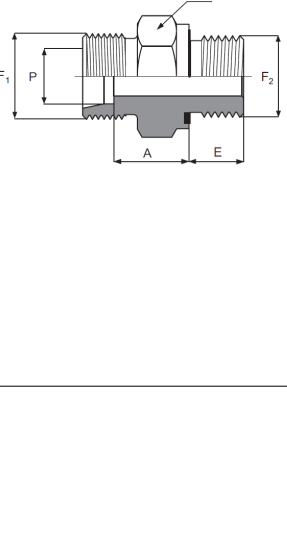

**AS10124**  
METRIC MALE HEAVY TYPE  
(DN 25SS)  
METRIC MALE  
(DN 38S2-1)

Nr części	Gwint		Ciężnienie robocze	Wymiary			
	F1 (METR)	F2 (METR)		bar	P	A	H
AS10124-06-12	M14x1,5	M12x1,5	630	6,0	13,0	17	12,0
AS10124-08-14	M16x1,5	M14x1,5	630	8,0	15,0	19	12,0
AS10124-10-16	M18x1,5	M16x1,5	630	10,0	15,0	22	12,0
AS10124-12-18	M20x1,5	M18x1,5	630	12,0	17,0	24	12,0
AS10124-14-20	M22x1,5	M20x1,5	630	14,0	19,0	27	14,0
AS10124-16-18	M24x1,5	M18x1,5	400	16,0	18,0	27	12,0
AS10124-16-22	M24x2,0	M22x1,5	400	16,0	18,0	27	14,0
AS10124-20-27	M30x2,0	M27x2,0	400	20,0	26,5	32	16,0
AS10124-25-27	M36x2	M27x2	400	25,0	23	41	16
AS10124-25-33	M36x2	M33x2,0	400	25,0	23	41	18,0
AS10124-30-42	M42x2,0	M42x2,0	400	30,0	23,0	50	20,0
AS10124-38-48	M52x2,0	M48x2,0	315	38,0	26,0	55	22,0

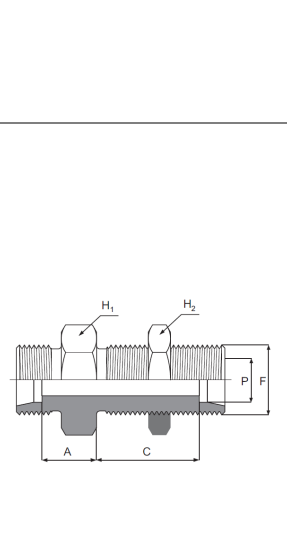

**AS10128**  
METRIC MALE HEAVY TYPE  
(DN 25SS)  
NPTF MALE  
(SAE J1926)

Nr części	Gwint		Ciężnienie robocze	Wymiary			
	F1 (METR)	F2 (NPTF)		bar	P	A	H
AS10128-06-04	M14x1,5	1/4" - 18	630	6,0	11,0	17	16,0
AS10128-08-04	M16x1,5	1/4" - 18	630	8,0	13,0	17	15,0
AS10128-10-06	M18x1,5	3/8" - 18	630	10,0	12,0	19	15,0
AS10128-12-06	M20x1,5	3/8" - 18	630	12,0	14,0	22	15,0
AS10128-14-08	M22x1,5	1/2" - 14	630	14,0	16,0	24	19,5
AS10128-16-08	M24x1,5	1/2" - 14	400	16,0	16,0	27	19,5
AS10128-20-10	M30x2,0	3/4" - 14	400	20,0	17,5	32	20,0
AS10128-25-16	M36x2,0	1" - 11 1/2	400	25,0	20,0	41	25,0
AS10128-30-20	M42x2,0	1" - 11 1/2	400	30,0	21,0	46	25,0

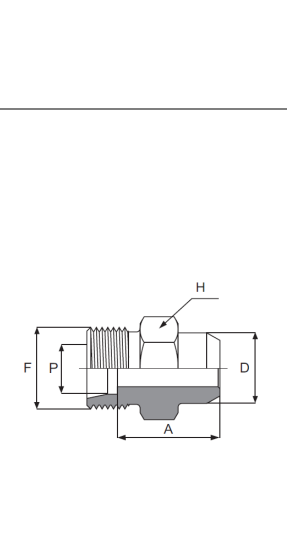

**AS10130**  
METRIC MALE HEAVY TYPE  
(DN 25SS)  
SAE MALE ORING  
BSP TYPE  
(SAE J1926)

Nr części	Gwint		Ciężnienie robocze	Wymiary			
	F1 (METR)	F2 (UNF)		bar	P	A	H
AS10130-08-04	M16x1,5	7/16 - 20	630	8,0	14,0	17	9,1
AS10130-10-06	M18x1,5	9/16 - 18	630	10,0	14,5	19	10,0
AS10130-12-06	M20x1,5	9/16 - 18	630	12,0	14,5	22	10,0
AS10130-16-08	M24x1,5	3/4" - 16	400	16,0	15,4	27	11,1
AS10130-16-10	M24x1,5	7/8 - 14	400	16,0	18,0	27	12,7
AS10130-20-08	M30x2,0	3/4" - 16	400	20,0	20,4	32	11,1
AS10130-20-10	M30x2,0	7/8 - 14	400	20,0	20,8	32	12,7
AS10130-20-12	M30x2,0	1 1/16 - 12	400	20,0	20,4	32	15,1



**AS101287**  
METRIC MALE HEAVY TYPE  
(DN 25SS)  
METRIC MALE  
HEAVY TYPE  
(DN 25SS)

Nr części	Gwint		Ciężnienie robocze	Wymiary			
	F1 (METR)	F2 (METR)		bar	P	A	H
AS101287-06-06	M14x1,5	630	6,0	12,0	19	29,0	
AS101287-08-08	M16x1,5	630	8,0	13,0	22	29,0	
AS101287-10-10	M18x1,5	630	10,0	14,5	24	29,5	
AS101287-12-12	M20x1,5	630	12,0	14,5	27	29,5	
AS101287-14-14	M22x1,5	630	14,0	17,0	30	31,5	
AS101287-16-16	M24x1,5	400	16,0	16,5	32	32,0	
AS101287-20-20	M30x2,0	400	20,0	17,5	41	33,5	
AS101287-25-25	M36x2,0	400	25,0	20,0	46	36,0	
AS101287-30-30	M42x2,0	400	30,0	21,5	50	37,0	
AS101287-38-38	M52x2,0	315	38,0	22,0	65	65	37,0

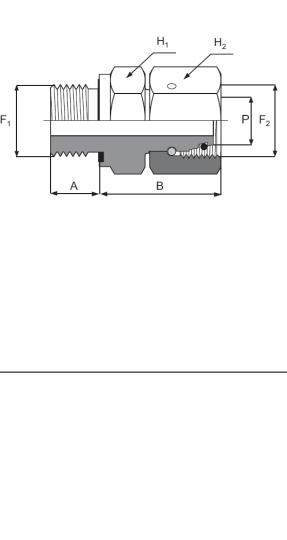

**AS101288**  
METRIC MALE HEAVY TYPE  
(DN 25SS)  
METRIC MALE TAPERED

Nr części	Gwint		Ciężnienie robocze	Wymiary			
	F1 (METR)	F2 (METR)		bar	P	A	H
AS101288-06-12	M14x1,5	M12x1,5	630	6,0	11,0	17	12,0
AS101288-08-14	M16x1,5	M14x1,5	630	8,0	13,0	17	12,0
AS101288-10-16	M18x1,5	M16x1,5	630	10,0	12,0	19	12,0
AS101288-12-18	M20x1,5	M18x1,5	630	12,0	14,5	22	12,0
AS101288-14-20	M22x1,5	M20x1,5	630	14,0	16,0	24	14,0
AS101288-16-22	M24x1,5	M22x1,5	400	16,0	16,5	27	14,0

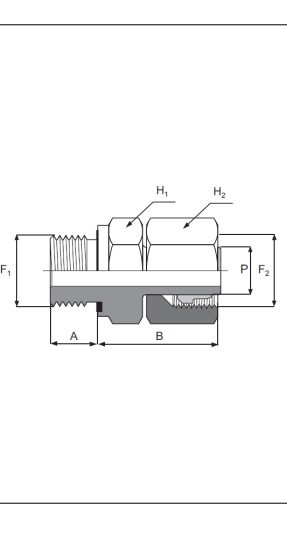

**AS101295**  
METRIC MALE HEAVY TYPE  
(DN 25SS)  
WELDING PIPE

Nr części	Gwint		Ciężnienie robocze	Wymiary			
	F1 (METR)	F2 (UNF)		bar	P	A	H
AS101295-06-11	M14x1,5	7/16 - 20	630	6,0	19,0	14	11,0
AS101295-08-13	M16x1,5	9/16 - 18	630	8,0	21,0	17	13,0
AS101295-10-15	M18x1,5	9/16 - 18	630	10,0	22,5	19	15,0
AS101295-12-17	M20x1,5	9/16 - 18	630	12,0	24,5	22	17,0
AS101295-14-19	M22x1,5	3/4" - 16	400	14,0	26,0	24	19,0
AS101295-16-21	M24x1,5	7/8 - 14	400	16,0	27,5	27	21,0
AS101295-20-26	M30x2,0	3/4" - 16	400	20,0	29,0	41	26,0
AS101295-25-31	M36x2,0	1" - 11 1/2	400	25,0	32,5	41	31,0
AS101295-30-36	M42x2,0	1" - 11 1/2	400	30,0	35,5	46	36,0
AS101295-38-44	M52x2,0	1 1/4" - 12	315	38,0	38,0	55	44,0

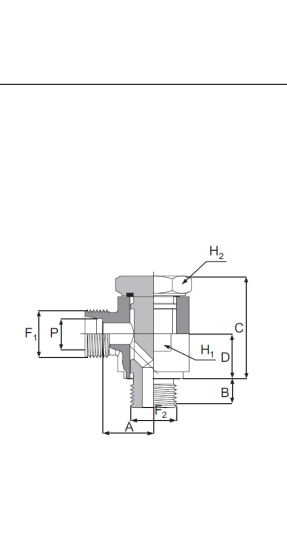

**AS11515**  
METRIC FEMALE CONNECTOR  
STRAIGHT COUPLING  
WITH SWIVEL NUT  
(DN 25SS)  
NEW

Nr części	Gwint		Ciężnienie robocze	Wymiary			
	F1 (METR)	F2 (METR)		bar	P	A	H
AS11515-06-06	M14x1,5	M12x1,5	315	6	40	14	17
AS11515-08-08	M16x1,5	M14x1,5	315	8	40	17	19
AS11515-10-10	M18x1,5	M16x1,5	315	10	39	19	22
AS11515-12-12	M20x1,5	M18x1,5	315	12	39	22	24
AS11515-15-15	M22x1,5	M20x1,5	315	15	45	27	27
AS11515-18-18	M24x1,5	M22x1,5	315	18	48	32	32
AS11515-22-22	M30x2	M30x2	160	22	48	36	36
AS11515-28-28	M36x2	M36x2	160	28	49	41	41
AS11515-35-35	M45x2	M45x2	160	35	60	50	50
AS11515-42-42	M52x2	M52x2	160	42	60	60	60



**AS11616**  
METRIC FEMALE CONNECTOR  
STRAIGHT COUPLING  
WITH SWIVEL NUT  
(DN 25SS)  
NEW

Nr części	Gwint		Ciężnienie robocze	Wymiary			
	F1 (METR)	F2 (METR)		bar	P	A	H
AS11616-06-06	M14x1,5	M12x1,5	630	6	37	17	17
AS11616-08-08	M16x1,5	M14x1,5	630	8	38	19	19
AS11616-10-10	M18x1,5	M16x1,5	630	10	44	24	24
AS11616-12-12	M20x1,5	M18x1,5	630	12	44	24	24
AS11616-14-14	M22x1,5	M20x1,5	630	14	44	27	27
AS11616-16-16	M24x1,5	M22x1,5	400	16	51	30	30
AS11616-20-20	M30x2,0	M30x2,0	400	20	56	36	36
AS11616-25-25	M36x2,0	M36x2,0	400	25	60	46	46
AS11616-30-30	M42x2,0	M42x2,0	400	30	62	50	50
AS11616-38-38	M52x2,0	M52x2,0	315	38	70	60	60

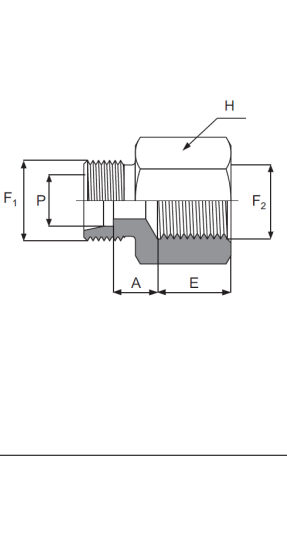

**AS20615**  
BSP MALE LIGHT TYPE  
(DN 25SS)  
METRIC FEMALE LIGHT TYPE  
(DN 25SS)

Nr części	Gwint		Ciężnienie robocze	Wymiary				
	F1 (BSP)	F2 (METR)		bar	P	A	H	H2
AS20615-02-06	1/8" - 28	M12x1,5	315	6,0	8,0	14	14	24,5
AS20615-04-08	1/4" - 19	M14x1,5	315	8,0	12,0	19	17	29,5
AS20615-06-10	3/8" - 19	M16x1,5	315	10,0	12,0	19	19	27,5
AS20615-08-12	1/2" - 14	M18x1,5	315	12,0	12,0	22	22	34,0
AS20615-08-15	1/2" - 14	M22x1,5	315	12,0	14,0	27	27	32,0
AS20615-08-18	1/2" - 14	M26x1,5	160	18,0	14,0	32	32	36,5
AS20615-12-22	3/4" - 14	M30x2,0	160	22,0	16,0	32	32	36,5
AS20615-16-28	1" - 11	M36x2,0	160	28,0	18,0	41	41	36,5
AS20615-20-35	1 1/4" - 11	M42x2,0	160	30,0	20,0	50	50	42,0
AS20615-24-42	1 1/2" - 11	M52x2,0	160	42,0	22,0	55	60	46,5

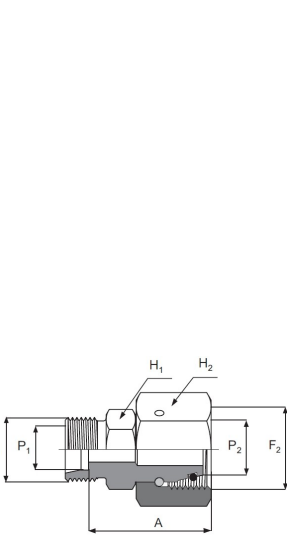

**AS20616**  
BSP MALE STANDPIPE LIGHT TYPE  
(DN 25SS)  
METRIC FEMALE STANDPIPE LIGHT TYPE  
(DN 25SS)

Nr części	Gwint		Ciężnienie robocze	Wymiary				
	F1 (BSP)	F2 (METR)		bar	P	A	H	H2
AS20616-04-06	1/4" - 19	M14x1,5	630	6,0	12,0	19	17	27,0
AS20616-04-08	1/4" - 19	M16x1,5	630	8,0	12,0	19	19	29,5
AS20616-06-10	3/8" - 19	M18x1,5	630	10,0	12,0	19	22	32,0
AS20616-08-12	1/2" - 14	M20x1,5	630	12,0	12,0	22	24	34,0
AS20616-08-14	1/2" - 14	M22x1,5	630	14,0	14,0	27	27	36,5
AS20616-08-16	1/2" - 14	M24x1,5	400	16,0	14,0	27	30	37,0
AS20616-08-20	1/2" - 14	M30x2,0	400	20,0	16,0	32	36	43,0
AS20616-12-20	3/4" - 14	M30x2,0	400	25,0	18,0	32	36	43,0
AS20616-16-25	1" - 11	M36x2,0	400	28,0	18,0	41	46	48,0
AS20616-20-30	1 1/4" - 11	M42x2,0	400	30,0	20,0	50	50	51,0
AS20616-24-38	1 1/2" - 11	M52x2,0	315	38,0	22,0	55	60	60,0



**AS20620**  
BSP MALE STANDPIPE LIGHT TYPE  
(DN 25SS)  
METRIC FEMALE STANDPIPE LIGHT TYPE  
(DN 25SS)

Nr części	Gwint		Ciężnienie robocze	Wymiary				
	F1 (BSP)	F2 (METR)		bar	P	A	H	H2
AS20620-02-06	1/8" - 28	M12x1,5	315	6,0	8,0	14	14	24,5
AS20620-04-08	1/4" - 19	M14x1,5	315	8,0	12,0	19	17	29,5
AS20620-06-10	3/8" - 19	M16x1,5	315	10,0	12,0	19	19	27,5
AS20620-08-12	1/2" - 14	M18x1,5	315	12,0	12,0	22	22	34,0
AS20620-08-15	1/2" - 14	M22x1,5	315	12,0	14,0	27	27	32,0
AS20620-08-18	1/2" - 14	M26x1,5	315	18,0	14,0	27	27	32,0</

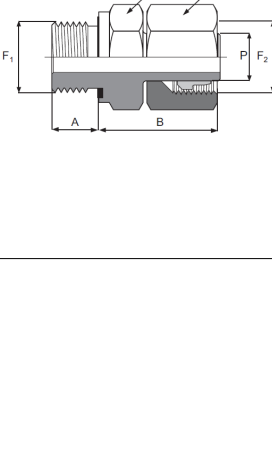

**AS21421**  
METRIC FEMALE  
STANDPIPE HEAVY TYPE  
(DIN 2353)

Nr części	Gwint		Ciężnienie robocze	Wymiary			
	F1 (METR)	F2 (METR)		bar	P	A	H1 H2 B
AS21421-12-06	M12x1,5	M14x1,5	630	6,0	12,0	17	27,0
AS21421-14-08	M14x1,5	M16x1,5	630	8,0	12,0	19	29,0
AS21421-16-10	M16x1,5	M18x1,5	630	10,0	12,0	22	32,0
AS21421-18-12	M18x1,5	M20x1,5	630	12,0	12,0	24	34,0
AS21421-20-14	M20x1,5	M22x1,5	630	14,0	14,0	27	36,0
AS21421-22-16	M22x1,5	M24x1,5	400	16,0	14,0	27	37,0
AS21421-24-18	M24x1,5	M26x1,5	400	20,0	16,0	32	43,0

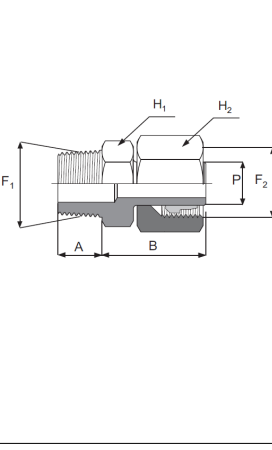

**AS21695**  
WELDING FITTING  
WITH ORING  
HEAVY TYPE  
(DIN 2353)

Nr części	Gwint		Ciężnienie robocze	Wymiary			
	F1 (NPTF)	F2 (METR)		W.P. (bar)	P	A	H1 H2 B
AS21695-08-08	1/8" - 27	M12x1,5	315	6,0	31,0	4,0	
AS21695-10-10	1/8" - 18	M14x1,5	400	10,0	32,5	6,0	
AS21695-12-12	3/8" - 18	M16x1,5	630	12,0	32,5	7,0	
AS21695-14-14	1/2" - 14	M18x1,5	400	14,0	38,5	8,0	
AS21695-16-16	3/4" - 14	M20x1,5	400	16,0	39,0	10,0	
AS21695-20-20	1" - 11/2	M24x1,5	250	20,0	45,0	12,0	
AS21695-25-25	1 1/4" - 11/2	M28x1,5	315	25,0	49,5	17,0	
AS21695-30-30	1 1/2" - 11/2	M32x1,5	250	30,0	52,0	22,0	
AS21695-38-32	1 3/4" - 11/2	M36x1,5	250	38,0	56,5	28,0	

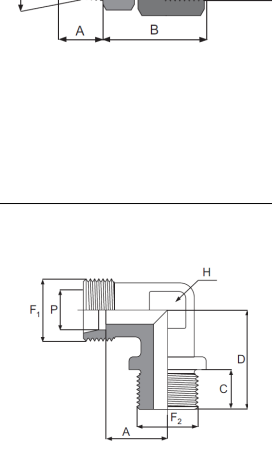

**AS22820**  
METRIC FEMALE  
STANDPIPE LIGHT TYPE  
(DIN 2353)

Nr części	Gwint		Ciężnienie robocze	Wymiary			
	F1 (NPTF)	F2 (METR)		W.P. (bar)	P	A	H1 H2 B
AS22820-02-06	1/8" - 27	M12x1,5	315	6,0	10,0	12	14
AS22820-04-08	1/8" - 18	M14x1,5	315	8,0	15,0	14	23,0
AS22820-04-10	1/8" - 18	M14x1,5	315	10,0	15,0	14	23,5
AS22820-06-12	3/8" - 18	M16x1,5	315	12,0	15,0	19	22
AS22820-08-15	1/2" - 14	M22x1,5	315	18,0	19,5	22	29,0
AS22820-08-18	1/2" - 14	M22x1,5	315	18,0	19,5	22	32,0
AS22820-12-22	3/4" - 14	M30x2,0	160	22,0	23,0	27	36
AS22820-16-28	1" - 11/2	M36x2,0	160	28,0	23,0	40	46
AS22820-20-35	1 1/4" - 11/2	M42x2,0	160	35,0	25,5	46	50
AS22820-24-42	1 1/2" - 11/2	M52x2,0	160	42,0	26,0	50	60

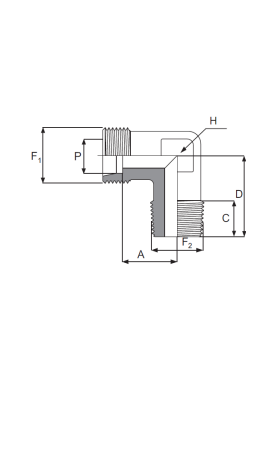

**AS22821**  
METRIC FEMALE  
STANDPIPE HEAVY TYPE  
(DIN 2353)

Nr części	Gwint		Ciężnienie robocze	Wymiary			
	F1 (NPTF)	F2 (METR)		bar	P	A	H1 H2 B
AS22821-04-06	1/4" - 18	M14x1,5	630	6,0	15,0	14	25,0
AS22821-04-08	1/4" - 18	M14x1,5	630	8,0	15,0	14	27,5
AS22821-06-10	3/8" - 18	M16x1,5	630	10,0	15,0	19	29,5
AS22821-06-12	3/8" - 18	M20x1,5	630	12,0	15,0	19	31,5
AS22821-08-16	1/2" - 14	M24x1,5	400	16,0	19,5	22	30
AS22821-10-20	3/4" - 14	M30x2,0	400	20,0	20,0	27	36
AS22821-16-25	1" - 11/2	M36x2,0	400	25,0	25,5	36	46,0
AS22821-20-30	1 1/4" - 11/2	M42x2,0	400	30,0	25,5	46	50
AS22821-24-38	1 1/2" - 11/2	M52x2,0	315	38,0	26,0	50	60

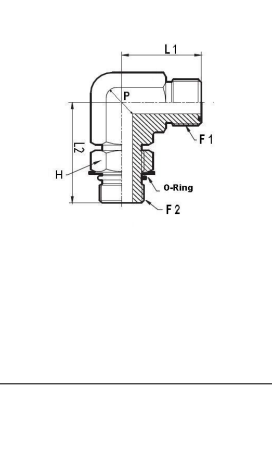

**AS51106**  
METRIC MALE LIGHT TYPE  
LIGHT SERIES  
BSP FLAT FACE MALE  
90° ELBOW  
(ISO 1793)

Nr części	Gwint		Ciężnienie robocze	Wymiary			
	F1 (METR)	F2 (BSP)		bar	P	A	H C D
AS51106-22-12	M30x2,0	1/2" - 14	160	22,0	27,5	27	15,0 43,5
AS51106-25-16	M36x2,0	1" - 11	160	25,0	30,5	36	17,0 49,0
AS51106-35-20	M45x2,0	1 1/4" - 11	160	35,0	34,5	41	19,0 57,0
AS51106-42-24	M52x2,0	1 1/2" - 11	160	42,0	40,0	50	20,0 64,0

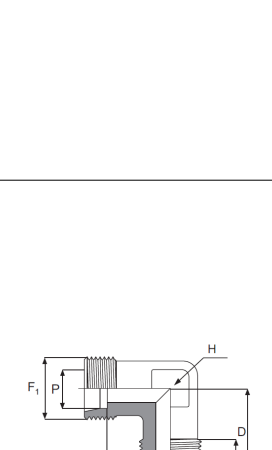

**AS51107**  
METRIC MALE LIGHT TYPE  
LIGHT SERIES  
BSP MALE TAPERED  
(ISO 70°)  
90° ELBOW

Nr części	Gwint		Ciężnienie robocze	Wymiary			
	F1 (METR)	F2 (BSPT)		bar	P	A	H C D
AS51107-06-02	M12x1,5	1/8" - 28	315	6,0	12,0	12	8,0 20,0
AS51107-06-04	M12x1,5	1/4" - 19	315	6,0	14,0	12	8,0 20,0
AS51107-08-04	M14x1,5	1/8" - 28	315	8,0	14,0	12	8,0 22,0
AS51107-08-04	M14x1,5	3/8" - 19	315	8,0	14,0	12	12,0 26,0
AS51107-08-06	M14x1,5	1/2" - 14	315	8,0	16,0	17	12,0 28,0
AS51107-10-02	M16x1,5	1/8" - 28	315	10,0	15,0	14	8,0 22,0
AS51107-10-04	M16x1,5	1/4" - 19	315	10,0	15,0	14	12,0 27,0
AS51107-10-06	M16x1,5	3/8" - 19	315	10,0	17,0	17	12,0 28,0
AS51107-12-04	M18x1,5	1/4" - 19	315	12,0	17,0	17	12,0 28,0
AS51107-12-06	M18x1,5	3/8" - 19	315	12,0	17,0	17	14,0 34,0
AS51107-12-08	M18x1,5	1/2" - 14	315	12,0	20,0	19	14,0 36,0
AS51107-15-06	M22x1,5	3/8" - 19	315	15,0	21,0	19	12,0 30,0
AS51107-15-08	M22x1,5	1/2" - 14	315	15,0	21,0	19	14,0 34,0
AS51107-18-08	M26x1,5	1/2" - 14	315	18,0	23,5	24	14,0 36,0
AS51107-22-12	M30x2,0	3/4" - 14	160	22,0	27,5	27	16,0 42,0
AS51107-28-16	M36x2,0	1" - 11	160	28,0	30,5	36	18,0 54,0
AS51107-35-20	M45x2,0	1 1/4" - 11	160	35,0	34,5	41	20,0 60,0
AS51107-42-24	M52x2,0	1 1/2" - 11	160	42,0	40,0	50	22,0 61,0

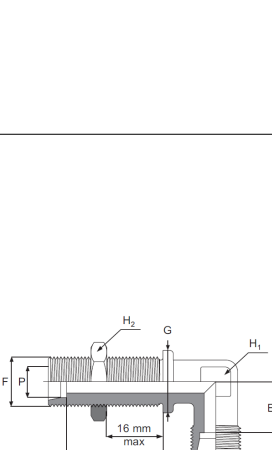

**AS51109**  
METRIC MALE LIGHT TYPE  
LIGHT SERIES  
BSP MALE ORING  
(ISO 1793°)  
90° ELBOW

Nr części	Gwint		Ciężnienie robocze	Wymiary			
	F1 (METR)	F2 (BSP)		W.P.	L1	L2	H P
AS51109-06-02	M12x1,5	1/8" - 28	315	6,0	12,0	12	8,0 20,0
AS51109-06-04	M12x1,5	1/4" - 19	315	6,0	14,0	12	8,0 20,0
AS51109-08-04	M14x1,5	1/8" - 28	315	8,0	14,0	12	8,0 22,0
AS51109-08-04	M14x1,5	3/8" - 19	315	8,0	14,0	12	12,0 26,0
AS51109-10-04	M16x1,5	1/4" - 19	315	10,0	15,0	14	8,0 22,0
AS51109-10-04	M16x1,5	3/8" - 19	315	10,0	17,0	17	12,0 28,0
AS51109-12-06	M18x1,5	1/2" - 14	250	12,0	20,0	19	14,0 32,0
AS51109-15-08	M22x1,5	1/2" - 14	250	15,0	21,0	19	14,0 34,0
AS51109-18-08	M26x1,5	1/2" - 14	250	18,0	23,5	24	14,0 36,0
AS51109-22-12	M30x2,0	3/4" - 14	160	22,0	27,5	27	16,0 42,0
AS51109-28-16	M36x2,0	1" - 11	160	28,0	30,5	36	18,0 54,0
AS51109-35-20	M45x2,0	1 1/4" - 11	160	35,0	34,5	41	20,0 60,0
AS51109-42-24	M52x2,0	1 1/2" - 11	160	42,0	40,0	50	22,0 61,0

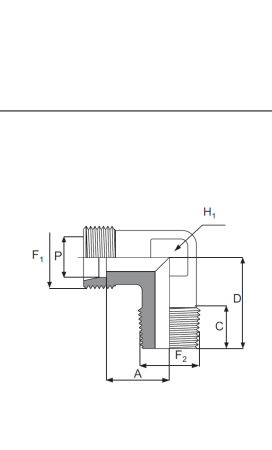

**AS51111**  
METRIC MALE LIGHT TYPE  
LIGHT SERIES  
90° EQUAL ELBOW

Nr części	Gwint		Ciężnienie robocze	Wymiary			
	F1 (METR)	F2 (BSP)		bar	P	A	H C D
AS51111-06-06	M12x1,5	1/8" - 28	315	6,0	12,0	12	8,0 20,0
AS51111-08-08	M14x1,5	1/4" - 19	315	8,0	14,0	12	8,0 22,0
AS51111-10-10	M16x1,5	1/4" - 19	315	10,0	15,0	14	8,0 22,0
AS51111-12-12	M18x1,5	1/2" - 14	315	12,0	17,0	17	12,0 28,0
AS51111-15-15	M22x1,5	1/2" - 14	315	15,0	21,0	19	14,0 34,0
AS51111-18-18	M26x1,5	1/2" - 14	315	18,0	23,5	24	14,0 36,0
AS51111-22-22	M30x2,0	3/4" - 14	160	22,0	27,5	27	16,0 42,0
AS51111-28-28	M36x2,0	1" - 11	160	28,0	30,5	36	18,0 54,0
AS51111-35-35	M45x2,0	1 1/4" - 11	160	35,0	34,5	41	20,0 60,0
AS51111-42-42	M52x2,0	1 1/2" - 11	160	42,0	40,0	50	22,0 61,0

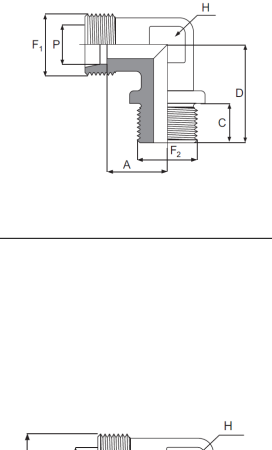

**AS51128**  
METRIC MALE LIGHT TYPE  
LIGHT SERIES  
NPT MALE  
90° ELBOW  
(SAE J476A)

Nr części	Gwint		Ciężnienie robocze	Wymiary			
	F1 (METR)	F2 (NPT)		bar	P	A	H1 C D
AS51128-06-02	M12x1,5	1/8" - 27	315	6,0	12,0	12	10,0 30,0
AS51128-08-04	M14x1,5	1/4" - 18	315	8,0	14,0	12	15,0 26,0
AS51128-10-04	M16x1,5	1/4" - 18	315	10,0	15,0	14	15,0 27,0
AS51128-12-06	M18x1,5	1/2" - 14	315	12,0	17,0	17	15,0 28,0
AS51128-15-06	M22x1,5	3/8" - 18	315	15,0	21,0	19	19,5 38,0
AS51128-18-08	M26x1,5	1/2" - 14	315	18,0	23,5	24	19,5 38,0
AS51128-22-12	M30x2,0	3/4" - 14	160	22,0	27,5	27	20,0 42,0
AS51128-28-16	M36x2,0	1" - 11/2	160	28,0	30,5	36	25,0 48,0
AS51128-35-20	M45x2,0	1 1/4" - 11/2	160	35,0	34,5	41	25,5 67,0



**AS51177**  
METRIC MALE HEAVY TYPE  
LIGHT SERIES  
90° ELBOW

Nr części	Gwint		Ciężnienie robocze	Wymiary					
	F (METR)	bar		P	A	H1	C	H2	E
AS51177-06-06	M12x1,5	315	6,0	14,0	12	27,0	17	12,0	17,0
AS51177-08-08	M14x1,5	315	8,0	17,0	12	27,0	17	14,0	19,0
AS51177-10-10	M16x1,5	315	10,0	18,0	14	28,0	22	15,0	22,0
AS51177-12-12	M18x1,5	315	12,0	20,0	17	29,0	24	17,0	24,0
AS51177-15-15	M22x1,5	315	15,0						