

Typ uszczelnienia :

S7

Materiał: PU

Szybkość przesuwu – 0,5m/s

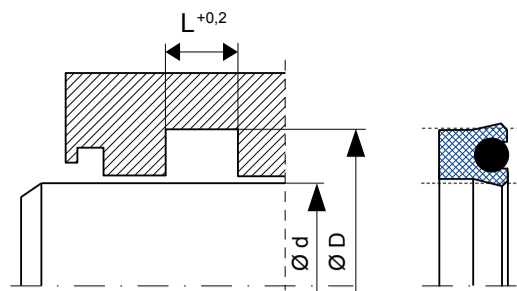

Ø d	Ø D	L	Numer katalogowy
8	15	4,3	S7-007.352
10	17	5,3	S7-007.358
12	19	6,3	S7-007.364
14	22	6,3	S7-027.629
15	23	6,3	S7-007.372
16	24	6,3	S7-027.652
18	25	6,3	S7-030.522
18	26	6,3	S7-007.379
20	28	6,3	S7-007.388
22	30	6,3	S7-007.397
24	32	6,3	S7-027.651
25	32	6,3	S7-060.408
25	33	6,3	S7-007.407
25	35	7,5	S7-055.606
28	36	6,3	S7-007.413
30	38	6,3	S7-027.648
30	38	8,5	S7-027.626
32	40	6,3	S7-023.604
35	43	6,3	S7-027.649
35	45	8	S7-007.446
36	44	6,3	S7-007.448
40	48	6,3	S7-007.461
40	48	8	S7-073.042
40	48	11,5	S7-007.465
40	50	8	S7-007.467
40	52	9,5	S7-030.126
42	50	6,3	S7-007.475
44	55	10,5	S7-094.781
45	53	8,5	S7-060.410
45	55	8	S7-007.485
48	60	10,5	S7-055.751
50	58	8,5	S7-117.303
50	60	8	S7-007.494
50	60	10,5	S7-135.436
50	62	9,5	S7-091.914
55	65	8	S7-027.658
55	67	10,5	S7-007.510
56	66	8	S7-007.513
60	70	8	S7-007.520
63	75	9,5	S7-007.539
65	77	9,5	S7-007.545
70	80	7,5	S7-084.356
70	82	9,5	S7-007.555
70	85	12,5	S7-007.558
75	87	9,5	S7-007.567
78	90	12,5	S7-067.016
80	92	9,5	S7-027.655
85	97	9,5	S7-007.587
85	100	12,5	S7-007.590
90	102	9,5	S7-007.602
90	105	12,5	S7-007.605
95	107	13	S7-070.580
100	115	12	S7-027.657
105	120	12,5	S7-007.629
110	125	12	S7-027.631
115	130	12	S7-007.645
120	135	12	S7-084.364
125	140	12	S7-027.653
130	142	9,5	S7-007.661
130	145	11	S7-031.801
135	150	11	S7-027.636
140	155	14	S7-057.871
140	160	16	S7-007.671
150	170	16	S7-007.682
155	175	16	S7-007.685
160	180	16	S7-027.656
165	185	16	S7-007.694
170	190	16	S7-091.141
180	200	16	S7-007.703
200	220	16	S7-007.710
210	230	17	S7-065.708
220	240	16	S7-139.773
240	260	16	S7-091.143