

Typ uszczelnienia :

S1

Materiał: NBR; PU

Szybkość przesuwu – 0,5m/s

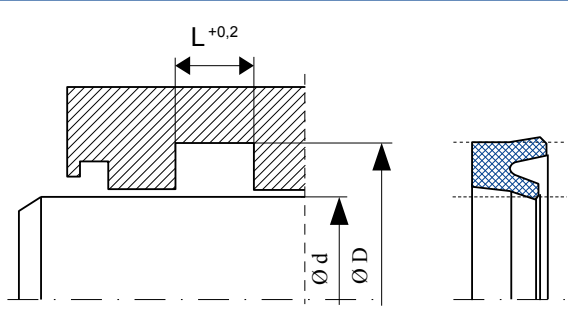

| Ø d | Ø D | L | Numer katalogowy |
|-----|-----|------|------------------|
| 8 | 16 | 6,3 | S1-223.246 |
| 8 | 16 | 9 | S1-223.247 |
| 10 | 18 | 6,3 | S1-223.248 |
| 10 | 20 | 8 | S1-223.249 |
| 10 | 20 | 9 | S1-223.253 |
| 12 | 20 | 6,3 | S1-223.254 |
| 12 | 22 | 8 | S1-223.255 |
| 12 | 22 | 9 | S1-187.190 |
| 14 | 22 | 6,3 | S1-268.060 |
| 14 | 24 | 8 | S1-223.256 |
| 14 | 24 | 9 | S1-223.257 |
| 15 | 25 | 9 | S1-223.258 |
| 16 | 24 | 6,3 | S1-223.260 |
| 16 | 26 | 8 | S1-223.261 |
| 16 | 26 | 9 | S1-223.262 |
| 18 | 26 | 6,3 | S1-268.070 |
| 18 | 26 | 9 | S1-223.263 |
| 18 | 28 | 8 | S1-223.264 |
| 18 | 28 | 9 | S1-187.191 |
| 20 | 28 | 6,3 | S1-223.265 |
| 20 | 30 | 8 | S1-223.266 |
| 20 | 30 | 9 | S1-187.192 |
| 22 | 30 | 6,3 | S1-236.862 |
| 22 | 30 | 9 | S1-223.267 |
| 22 | 32 | 8 | S1-223.268 |
| 22 | 32 | 9 | S1-187.193 |
| 25 | 33 | 6,3 | S1-223.269 |
| 25 | 35 | 8 | S1-223.070 |
| 25 | 35 | 9 | S1-223.271 |
| 25 | 40 | 11 | S1-223.272 |
| 28 | 36 | 6,3 | S1-237.159 |
| 28 | 36 | 11 | S1-223.273 |
| 28 | 38 | 8 | S1-223.274 |
| 28 | 38 | 9 | S1-187.195 |
| 28 | 40 | 11 | S1-223.275 |
| 28 | 43 | 12,5 | S1-261.406 |
| 30 | 38 | 6,3 | S1-236.861 |
| 30 | 38 | 9 | S1-223.276 |
| 30 | 40 | 11 | S1-187.196 |
| 30 | 45 | 11 | S1-223.277 |
| 32 | 40 | 6,3 | S1-234.472 |
| 32 | 42 | 8 | S1-223.278 |
| 32 | 42 | 11 | S1-223.279 |
| 32 | 47 | 11 | S1-187.197 |
| 35 | 43 | 6,3 | S1-236.860 |
| 35 | 45 | 11 | S1-187.198 |
| 35 | 50 | 11 | S1-187.199 |
| 36 | 44 | 6,3 | S1-266.873 |
| 36 | 46 | 8 | S1-223.280 |
| 36 | 46 | 11 | S1-187.200 |
| 40 | 48 | 6,3 | S1-239.428 |
| 40 | 48 | 9 | S1-223.281 |
| 40 | 50 | 8 | S1-223.283 |
| 40 | 50 | 9 | S1-223.282 |
| 40 | 50 | 11 | S1-187.702 |
| 40 | 55 | 11 | S1-187.203 |
| 40 | 55 | 12,5 | S1-261.407 |
| 42 | 50 | 6,3 | S1-261.932 |
| 42 | 52 | 11 | S1-223.284 |
| 45 | 53 | 9 | S1-223.285 |
| 45 | 55 | 8 | S1-223.286 |
| 45 | 55 | 11 | S1-223.287 |
| 45 | 60 | 11 | S1-187.204 |
| 50 | 58 | 9 | S1-223.250 |
| 50 | 60 | 8 | S1-223.251 |
| 50 | 60 | 11 | S1-187.205 |
| 50 | 62 | 11 | S1-223.289 |
| 50 | 65 | 11 | S1-187.206 |
| 50 | 65 | 12,5 | S1-223.290 |
| 50 | 70 | 13 | S1-223.291 |
| 55 | 63 | 8 | S1-236.859 |
| 55 | 63 | 9 | S1-223.292 |
| 55 | 65 | 8 | S1-239.429 |
| 55 | 65 | 11 | S1-187.207 |
| 55 | 65 | 13 | S1-187.208 |
| 55 | 70 | 11 | S1-238.292 |
| 55 | 70 | 13 | S1-187.209 |
| 56 | 66 | 8 | S1-266.874 |
| 56 | 66 | 9 | S1-223.293 |
| 56 | 66 | 11 | S1-236.884 |
| 56 | 71 | 12,5 | S1-223.294 |
| 56 | 71 | 13 | S1-223.295 |
| 60 | 70 | 8 | S1-236.858 |
| 60 | 70 | 11 | S1-223.296 |
| 60 | 70 | 13 | S1-187.211 |
| 60 | 75 | 12,5 | S1-223.297 |
| 60 | 75 | 13 | S1-187.212 |
| 63 | 73 | 13 | S1-223.298 |
| 63 | 75 | 9,6 | S1-246.801 |
| 63 | 78 | 12,5 | S1-223.299 |
| 65 | 75 | 13 | S1-187.213 |
| 65 | 77 | 9,6 | S1-251.887 |
| 65 | 80 | 13 | S1-223.300 |
| 65 | 85 | 13 | S1-223.301 |
| 70 | 80 | 13 | S1-187.214 |
| 70 | 82 | 9,6 | S1-236.857 |
| 70 | 85 | 11 | S1-233.880 |
| 70 | 85 | 12,5 | S1-212.669 |
| 70 | 85 | 13 | S1-223.302 |
| 70 | 90 | 13 | S1-223.304 |
| 70 | 90 | 16 | S1-223.303 |
| 75 | 85 | 12,5 | S1-227.939 |
| 75 | 87 | 9,6 | S1-266.875 |
| 75 | 90 | 11 | S1-223.305 |
| 80 | 90 | 13 | S1-223.306 |
| 80 | 92 | 9,6 | S1-241.622 |
| 80 | 95 | 12,5 | S1-223.307 |
| 80 | 95 | 13 | S1-187.220 |
| 80 | 92 | 9,6 | S1-241.622 |
| 80 | 95 | 12,5 | S1-223.307 |
| 80 | 95 | 13 | S1-187.220 |
| 80 | 100 | 13 | S1-223.308 |
| 80 | 100 | 16 | S1-223.309 |
| 85 | 95 | 12,5 | S1-213.882 |
| 85 | 97 | 9,6 | S1-266.876 |
| 85 | 100 | 12,5 | S1-223.310 |
| 85 | 100 | 13 | S1-194.923 |
| 90 | 102 | 9,6 | S1-251.888 |
| 90 | 105 | 12,5 | S1-223.311 |
| 90 | 105 | 13 | S1-223.312 |
| 90 | 110 | 13 | S1-223.313 |
| 100 | 115 | 11 | S1-235.802 |
| 100 | 115 | 12 | S1-266.877 |
| 100 | 115 | 13 | S1-223.314 |
| 100 | 120 | 12,5 | S1-223.315 |
| 100 | 120 | 13 | S1-223.316 |
| 100 | 120 | 16 | S1-187.222 |
| 105 | 115 | 12,5 | S1-213.883 |
| 105 | 125 | 16 | S1-223.317 |
| 110 | 125 | 12 | S1-239.427 |
| 110 | 130 | 16 | S1-223.318 |
| 115 | 130 | 12 | S1-251.889 |
| 115 | 135 | 16 | S1-223.319 |
| 120 | 140 | 16 | S1-223.320 |
| 125 | 140 | 12 | S1-251.890 |
| 125 | 145 | 16 | S1-223.321 |
| 130 | 140 | 16 | S1-213.884 |
| 130 | 150 | 16 | S1-223.322 |
| 140 | 160 | 16 | S1-223.323 |
| 150 | 170 | 16 | S1-223.324 |
| 150 | 180 | 19 | S1-223.325 |
| 160 | 180 | 16 | S1-266.878 |
| 160 | 185 | 16 | S1-223.326 |
| 180 | 200 | 16 | S1-223.327 |
| 180 | 205 | 16 | S1-223.328 |
| 200 | 220 | 16 | S1-223.329 |
| 200 | 225 | 16 | S1-223.330 |
| 220 | 240 | 16 | S1-223.331 |
| 220 | 250 | 19 | S1-223.332 |
| 230 | 250 | 16 | S1-223.336 |
| 250 | 280 | 19 | S1-223.333 |
| 280 | 310 | 19 | S1-223.334 |